



# 2018

ANNUAL REPORT  
DEPARTMENT OF URBAN AND  
RURAL DEVELOPMENT

THE YEAR THAT PASSED	3
CALENDAR 2018	4
SUBJECT CHAIRS 2018	8
EDUCATION ON BASIC AND ADVANCED LEVEL	10
EXTERNAL COLLABORATION	11
FACTS & FIGURES	12

## THE DEPARTMENT OF URBAN AND RURAL DEVELOPMENT IN 2018

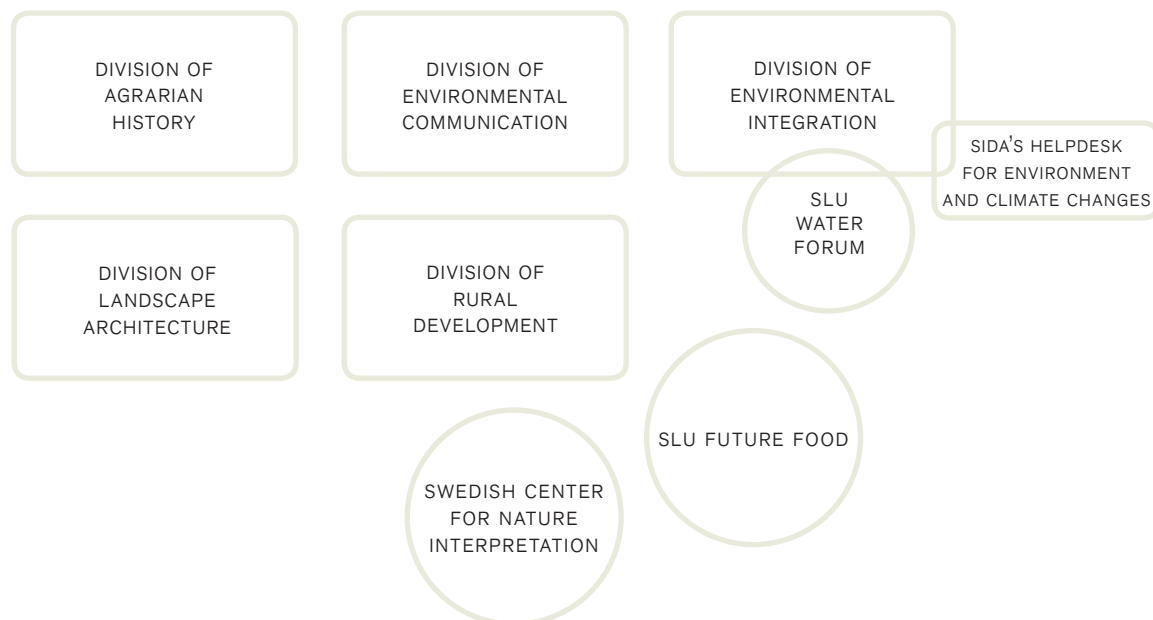

# THE YEAR THAT PASSED

It has been a very busy year—as expected at a large and vigorous department. We have continued to expand and were at the end of 2018 close to 140 persons working here; pursuing education, research and external collaboration. During the year we have had the pleasure of welcoming a large number of new doctoral students within all the subjects at the department, and have seen three doctoral dissertations successfully defended. In addition, two persons at the department achieved associate professorship in 2018.

The KON evaluation (on the quality and impact of our research) was an important feature this year. In the beginning of fall we received the results, which were overall very good for our five Units of Assessments (UoA), something that we of course are very proud of. The SLU vision of doubling the number of students by 2027 has also been much present in discussions over the year.

The generation shift continued among the higher positions and the department keeps developing in new and exciting directions. New subject chairs were appointed during the year and further changes are to come. At present there are seven subject chairs at the department.

The department's collaboration with surrounding society is far reaching. It is carried out as an important part of our research and education and through the work of the departmental units: Swedish Centre for Nature Interpretation, Division of Environmental Integration with SIDA Helpdesk for Environment and Climate Change and the research platform SLU Future Food. As part of our strategic development we aim to further strengthen our external collaboration and seize the experiences and knowledge developed in and through the collaboration processes that we are engaged in.

Research applications resulted in over 51 million SEK in grants in 2018—a new record. We have been working with ways of improving the support we give each other in the application process, which has been highlighted as a part of the success. We will continue working for more collegial support, integration across divisions and in improving our ways of working in 2019. Looking back at a year like 2018, inspires confidence in taking on 2019.

*Lars & Flora*



LARS JOHANSSON, HEAD OF DEPARTMENT &  
FLORA HAJDU, VICE HEAD OF DEPARTMENT.  
PHOTO: PETTER ÅKERBLÖM.

# CALENDAR 2018

## ■ JANUARY 1

The Division of Environmental Integration is initiated at the department, a division working for increased environmental integration in various sectors in society. In 2018, the division mainly has two programmes; the Sida Helpdesk for Environment and Climate Changes and SLU Water Forum. Eva Stephansson is heading the division.



STAFF MEMBERS OF THE DIVISION OF ENVIRONMENTAL INTEGRATION: HANNA WOLF, SUSANNE VON WALTER, LISA MATTESES-ÅHRGREN, LINDA ENGSTRÖM, GÖRAN EK, EVA STEPHANSSON AND ANJA CHRISTINA BEIER. PHOTO: PER-ARNE KLASSON.



SARA GRÄSLUND. PHOTO: MALIN PLANTING.

## ■ JANUARY 1

Sara Gräslund starts her employment as Water Coordinator at SLU, her task being to establish SLU's Water Forum, which will promote increased use of expertise from SLU to contribute to Agenda 2030. The service is funded by the NJ Faculty, and is a part of the department, but the Forum will promote water activities throughout SLU.

## ■ MARCH 20

Johanna Widenberg receives an award from The Royal Swedish Academy of Letters, History and Antiquities for her monographic work *The Great Cattle Death (Den stora kreatursdöden)*.



JOHANNA WIDENBERG. PHOTO: JOHAN WICKSTRÖM.

## ■ MARCH 23

At the annual inauguration ceremony Patrick Svensson is officially installed as the new professor in agrarian history. His inauguration lecture concerns the issue of growth and inequality during the agricultural revolution.



PROFESSOR PATRICK SVENSSON GIVING HIS INAUGURATION LECTURE. PHOTO: JENNY SVENNÄS-GILLNER.

## ■ APRIL 9

Josefin Wangel gives her Associate Professor's (Docent) lecture in landscape architecture on *Systems Thinking and Scenarios for Sustainable Urban Futures*.



A SELFIE TAKEN BY ASSOCIATE PROFESSOR JOSEFIN WANGEL.



# CALENDAR 2018



THE GATHERING AT THE 2018 SOL DAY AT KRUSENBERG. THE PHOTO WAS TAKEN BY A STAFF MEMBER AT THE CONFERENCE HOTEL.

## ■ MAY 2

The department holds its annual SOL Day at the Krusenberg estate, 6 km south of Uppsala. It is a one-day retreat with interesting seminars and discussions, good food and historical walks in the beautiful surroundings, guided by researcher Clas Tollin from the Division of Agrarian History.

## ■ MAY 8

Andrea Maria Cantillo Carrero, student at the master's programme Environmental Communication and Management, receives the title Global Swede 2018.



ANDREA MARIA CANTILLO CARRERO (TO THE RIGHT), RECEIVING THE GLOBAL SWEDISH AWARD FROM CAMILLA MELLANDER, HEAD OF THE DEPARTMENT FOR TRADE PROMOTION, NATION BRANDING AND CSR. PHOTO: PER E KARLSSON.

## ■ JUNE 5

Five students at the Landscape Architect Programme in Uppsala are rewarded with the Uppsala Municipality Annual Scholarship for Theses: Maria Walter for her bachelor's thesis and Ebba Johansson, Gerda Peterson, Oskar Mellegård and Henrik Lizell for their master's theses.



HAPPY RECIPIENTS OF AWARDS. FROM TOP LEFT: MARIA WALTER, GERDA PETTERSON AND EBBA JOHANSSON. THE PHOTOS ARE TAKEN BY THE AWARD WINNERS.

## ■ JULY 1

During the Almedalen Week, SLU Future Food arranges a seminar on food contingency. Camilla Eriksson, researcher at the Division of Rural Development, participates with her research on how sustainable food system might also increase Sweden's preparedness for crisis.



THE COVER OF THE JOINT MASTER'S THESIS OF OSKAR MELLEGÅRD AND HENRIK LIZELL.

## ■ SEPTEMBER 21

Linda Engström defends her doctoral thesis in rural development, *Development Delayed: Exploring the failure of a large-scale agricultural investment in Tanzania to deliver expected outcomes*.



THE CROWDED SEMINAR ARRANGED BY SLU FUTURE FOOD, AT ALMEDALEN WEEK IN JULY. PHOTO: PETER RUTHERHAGEN.



LINDA ENGSTRÖM AT THE DISSERTATION, SUCCESSFULLY DEFENDING HER THESIS. PHOTO: LINDA ENGSTRÖM.

# CALENDAR 2018



DR. DIL B. KHATRI AND FAMILY RIGHT AFTER THE ANNOUNCEMENT FROM THE EXAMINATION COMMITTEE AT THE DISSERTATION. PHOTO: DIL B. KHATRI.

## ■ SEPTEMBER 25

Dil B. Khatri defends his doctoral thesis in rural development on *Climate and Development at the Third Pole: Dynamics of power and knowledge reshaping community forest governance in Nepal*.

## ■ SEPTEMBER 27

The research platform SLU Future Food launches their new podcast *Feeding your Mind*, an interdisciplinary podcast that will address issues related to sustainable food systems. The first episode has the title *What is the future food*. The podcast is available through Podcaster and Soundcloud.



**FEEDING YOUR MIND**

## ■ OCTOBER 5

Louise Fortmann is appointed Honorary Doctor at the NJ Faculty. She is a pioneer in the field of rural development, especially within participatory and interdisciplinary research, and she mixes science and practical applications in a unique way also in her teaching. The title of her lecture is *Giving Credit where Credit is Due: Co-authoring in participatory research*.



LOUISE FORTMANN, A HAPPY HONORARY DOCTOR, PHOTOGRAPHED BY LAURA DRISCOLL.

## ■ OCTOBER 8–9

The Swedish Center for Nature Interpretation SCNI, celebrates its 10<sup>th</sup> anniversary, and as part of the year long celebration the center arranges a two-day conference on the theme *Nature Interpretation for the Future*.



THE KEYNOTE SPEAKERS AT THE CONFERENCE. FROM THE LEFT: EVA SANDBERG, DIRECTOR AT SCNI; CLAES SVELDINH, SWEDISH ENVIRONMENTAL PROTECTION AGENCY; MARY ALICE ARTHUR, STORYTELLING ACTIVIST FROM USA; CAROL RITCHIE, CEO AT EUROPARC FEDERATION AND REBECCA LE MOINE, APPOINTED ENVIRONMENTAL HERO 2017 BY WWF. PHOTO: LENA MALMSTRÖM.



# CALENDAR 2018

## ■ OCTOBER 9

Klara Fischer gives her Associate Professor's (Docent) lecture in rural development titled *How Agricultural Development can Better Attune to Farmers Perspectives and Practices*.



KLARA FISCHER GIVING HER ASSOCIATE PROFESSOR'S LECTURE. PHOTO: MARGARITA CUADRA.

## ■ NOVEMBER 22

The Agronomist programme for rural development celebrates ten years, highlighted at the yearly party arranged by the alumni network and attended by teachers. The SLU staff magazine *RESURS* honors the event in an article and the Agronomist Union magazine *Agronomen* dedicates an edition to rural development.

## ■ DECEMBER 6

Elvira Caselunghe defends her doctoral thesis in environmental communication: *Deliberations on Nature: Swedish cases of communication and democracy within nature conservation*.



ELVIRA CASELUNGHE CELEBRATING THE NAILING OF HER THESIS. PHOTO: LENA MALMSTRÖM.

## ■ DECEMBER 13

At the December gathering of The Royal Swedish Academy of Agriculture and Forestry (KSLA), Linley Chiwona Karlton, researcher at the Division of Rural Development, is elected new member of the Agricultural Section of KSLA.

## ■ DECEMBER 17

Helena Nordström Källström, researcher in environmental communication, is the first to receive the newly established SOL Environmental Challenge Award, for being this year's environmental motivator.

Helena is rewarded for travel by train despite her many different engagements where other's chose to fly, and moreover, for taking time to tell others about it. The reward ceremony is held at the staff Christmas party.



YVONNE GUNNARSDOTTER, ONE OF THE MINDS BEHIND THE RURAL DEVELOPMENT PROGRAMME, IS FEATURED IN BOTH RESURS AND THE AGRONOMIST UNION MAGAZINE. PHOTO: MÅRTEN GRANERT-GÄRDFELDT.



LINLEY CHIWONA KARLTUN, NEW MEMBER OF THE ROYAL SWEDISH ACADEMY OF AGRICULTURE AND FORESTRY. PHOTO: JENNY SVENNÄS-GILLNER.



HELENA NORDSTRÖM KÄLLSTRÖM, ON A BLACK FRIDAY SHOPPING SPREE AT A LOCAL PRODUCER OF ORGANIC FOOD. PHOTO: MALIN OHLSSON.

# SUBJECT CHAIRS 2018

PATRICK SVENSSON,  
PROFESSOR AND CHAIR  
AGRARIAN HISTORY  
PHOTO: JENNY  
SVENNÄS-GILLNER



## AGRARIAN HISTORY

Agrarian history is a historical discipline that encompasses a development from ancient times to the present. The subject is about agricultural production and technological development, social and economic conditions, people in the rural society and their relation to nature, the landscape and to society at large.

At present, three main research themes are at the center of the division's research agenda: Animal husbandry and veterinary public health, Transhumance, commons and property rights, and Agricultural growth and inequality. To this, several other topics are studied, such as garden history, pre-modern agricultural history and archeology, technological change and history of tools, markets and commercial development, and landscape and settlement history.

Research at the division combines theories, methods and source material from both humanities and natural science and by using Swedish contexts to address general problems it contributes to the international research agenda.

SEEMA ARORA-JONSSON,  
PROFESSOR AND CHAIR  
GLOBAL NORTH  
(SWEDEN AND EUROPE)  
PHOTO: MAYA  
ARORA-JONSSON



## RURAL DEVELOPMENT

The Division of Rural Development engages in international research, teaching and cooperation that contributes to scholarship, policy and practice on broad aspects of development and sustainability in rural areas. Across the globe, rural areas are undergoing rapid transformations caused by social and economic policies, globalization and climate and environmental change. We engage with issues of justice, knowledge and power in agriculture, forestry, development and environmental politics. By bringing to bear social science questions of gender, race, class, territory, state formation, scale, policy and development on the issues we study, we combat mainstream imaginations of the rural as residual, uninhabited, spaces for extraction and passive providers of food and natural resources. Our strength lies in our commitment to probing how development processes unfold through interdisciplinary conceptualizations and participatory methodologies.

Rural Development is an interdisciplinary field of study based in the social sciences, in which we pay special attention to how ideas about development have material consequences in the specific contexts of the Global North (specifically Sweden and Europe) and Global South. We nonetheless collaborate across our subjects to approach rural areas as dynamic material spaces made up of networks of relations that span between the rural and the urban, the Global North and South, paying attention to the particularities of the two contexts but also to the connections.

ANDREA NIGHTINGALE,  
PROFESSOR AND CHAIR  
GLOBAL SOUTH  
(ON SABBATICAL 2018)  
PHOTO: JENNY  
SVENNÄS-GILLNER  
(ACTING CHAIR 2018:  
FLORA HAJDU)



## LANDSCAPE ARCHITECTURE

Landscape architecture is an environmental discipline focusing on man and our outdoor environment. Landscape architecture involves planning, designing and managing the landscape to create, maintain, protect, preserve and develop sites and areas to make them effective, aesthetically pleasing, as well as economically, ecologically and socially sustainable.

The research at the division aims to develop knowledge about the theory and methods of planning, design and land management. The researchers at this division work partly with the scientific foundation of landscape architecture (substantive theory), but also with its applications and methods (procedural theory).



ÅSA AHRLAND,  
TEMPORARY CHAIR  
LANDSCAPE DESIGN  
PHOTO: ÅSA AHRLAND



MATTIAS QVISTRÖM,  
PROFESSOR AND CHAIR  
SPATIAL PLANNING  
PHOTO: JENNY  
SVENNÄS-GILLNER



THOMAS OLES,  
PROFESSOR AND  
CHAIR DESIGN THEORY  
PHOTO: JENNY  
SVENNÄS-GILLNER

## ENVIRONMENTAL COMMUNICATION

The Division of Environmental Communication is a cross-section of researchers jointly devoted to examining communication pertaining to environmental issues.

We work closely with practice, including public agencies, organisations and industry, to inform processes of public participation on the sustainable use and management of natural resources; we critically discuss and challenge scholarly perspectives on conflict, power, democratic legitimacy and social learning in environmental management; and we relate the material contexts of natural resources to global processes of communication, exploring, for example, the role of social movements, democratic challenges and sustainability discourses on environmental policy, its legitimacy and its compliance.



LOTTEN WESTBERG,  
TEMPORARY CHAIR  
ENVIRONMENTAL  
COMMUNICATION  
PHOTO: LOTTEN  
WESTBERG



# EDUCATION ON BASIC AND ADVANCED LEVEL

## PROGRAMMES AT THE DEPARTMENT 2018

### ON BASIC LEVEL

- AGRICULTURE–RURAL DEVELOPMENT  
5-year programme  
Yearly admission: 35 students
- LANDSCAPE ARCHITECT–UPPSALA  
5-year programme  
Yearly admission: 60 students

### ON ADVANCED LEVEL

- RURAL DEVELOPMENT AND NATURAL RESOURCE MANAGEMENT  
2-year international master's programme  
Yearly admission: 30 students
- LANDSCAPE ARCHITECTURE **NEW!**  
FOR SUSTAINABLE URBANISATION  
2-year international master's programme  
Yearly admission: 15 students
- ENVIRONMENTAL COMMUNICATION  
2-year international master's programme  
Yearly admission: 30 students

In 2018 our department educated 463 full-time equivalent students. This means that we are the second largest department at SLU as regards education, and that we train about 12% of SLU's total number of full-time equivalent students.

We give courses in mainly five programmes; two programmes on basic level, given in Swedish only: Agriculture–Rural Development Programme and the Landscape Architecture Programme–Uppsala; and two international master's programmes: the Environmental Communication Programme and the Rural Development and Natural Resource Management Programme. In the fall of 2018 we launched a new international master's programme in landscape architecture, Landscape Architecture for Sustainable Urbanisation, and welcomed seven new international students.

In the spring of 2018, second-year students at the Agriculture Programme–Rural Development pursued an externally funded project for the National Rural Network's Thematic group on Fishing and Aquaculture, all within the framework of two courses in the programme: Natural resource management (15 credits) and Organising, leadership, and learning (15 credits). They investigated the changes in preconditions and added values for the onshore fishing in four coastal communities in Sweden. The students conducted interviews and organised future workshops with a large number of stakeholders in four case study areas along the Swedish coast. The case studies offered valuable insights into the changed conditions for the onshore fishing and its significance to the development of the coastal communities.

The students presented their work continuously during the spring 2018, to the different communities, at the Swedish Rural Parliament in Örnköldsvik and at a finishing seminar held for the National Rural Network. Their work was also compiled into a popular scientific paper that was published in the department series *Urban and Rural reports*.

To give the students the opportunity to go through with an external project like this, within the framework of their regular education is rather unique. It offers the students close contact with 'reality' during their training, interspersing theory with practice, which is invaluable from a pedagogical perspective.

EXERCISE IN THE INTRODUCTORY COURSE  
FOR THE FIRST YEAR STUDENTS AT THE  
LANDSCAPE ARCHITECT PROGRAMME–UPPSALA.  
PHOTO: MARLÉN TÄLLEKLINT.







LEFT: STUDENTS VISITING THE NATIONAL RURAL NETWORK. IN 2018 THE DIVISION OF RURAL DEVELOPMENT WAS COMMISSIONED TO INVESTIGATE THE SIGNIFICANCE OF FISHING FOR VITAL COASTAL COMMUNITIES, ALL WITHIN THE FRAMEWORK OF TWO COURSES IN THE AGRICULTURE PROGRAMME- RURAL DEVELOPMENT. THE RESULTS OF THE PROJECT WERE PRESENTED AT A WORKSHOP DURING THE SWEDISH RURAL PARLIAMENT IN ÖRNSKÖLDSVIK IN MAY AND TO THE NATIONAL RURAL NETWORK. PHOTO: THOMAS NORRBY.

ABOVE: EVERY YEAR SCNI, TOGETHER WITH THE SWEDISH ENVIRONMENTAL PROTECTION AGENCY AND THE NATURAL HISTORY MUSEUM, EVALUATES A NUMBER OF THE SWEDISH NATURUMS (VISITORS' CENTERS IN CONNECTION TO AREAS OF PROTECTED NATURE). THE PHOTO WAS TAKEN AT ONE OF THESE VISITS, TO NATURUM FULUFJÄLLET, WITH THE PARTICIPANTS ENGAGED IN A DISCUSSION ON NATURE INTERPRETATION, THE RECEPTION OF VISITORS AND ON DESTINATION DEVELOPMENT. PHOTO: LENA MALMSTRÖM.

## EXTERNAL COLLABORATION

At the department we view collaboration with actors in society as a tool to contribute to a sustainable development, and as a method to conduct and continuously develop our research and education. During the year we have for instance played a major role in developing a pilot education at SLU called Leading collaboration (Att leda samverkan). We have participated in the development of a portfolio for collaboration at SLU and have contributed to a proposal for a new collaboration structure at SLU. Moreover, during the year the department has managed a great number of collaborative projects. The department has three established collaborative platforms: Swedish Center for Nature Interpretation (SCNI), Sida's Helpdesk for Environment and Climate Changes and the platform SLU Future Food. The SLU Water Forum was also coordinated from the department during most of the year.

The department's extensive efforts in external collaboration includes a special working group (Samverkansgruppen) with representatives from all units of the department.

They collect experience and knowledge from different collaborative processes at the department. During the year the group has, among other things, arranged three breakfast seminars:

Sara Gräslund from the SLU Water Forum talked on the subject how SLU's water research can attribute to Agenda 2030;

Lena Lidfors from the future platform Animals, Nature and Health talked about possibilities of financing and cooperations;

Mikael Jansson from the Communications Office talked about media training.

DURING 2018 A PILOT STUDY WAS CONDUCTED, AIMING AT A COLLABORATIVE RESEARCH PLANT AT ULTUNA WHERE SOLUTIONS FOR CIRCULAR AND SUSTAINABLE FOOD SYSTEMS COULD BE STUDIED, DEVELOPED AND TESTED.

THE PILOT STUDY, FUNDED BY REGION UPPSALA, WAS A COLLABORATION BETWEEN THE DEPARTMENT OF URBAN AND RURAL DEVELOPMENT, GREEN INNOVATION PARK, AKADEMISKA HUS, DEPT. OF ECONOMICS, DEPT. OF ANIMAL ENVIRONMENT AND HEALTH, RAMBÖLL, PROJEKTENGAGEMANG, CULTIVATING CITY BAZAARS AMONG OTHERS. THE PROJECT HAS BEEN GRANTED FUNDING BY REGION UPPSALA FOR FURTHER DEVELOPMENT DURING 2019-2020.

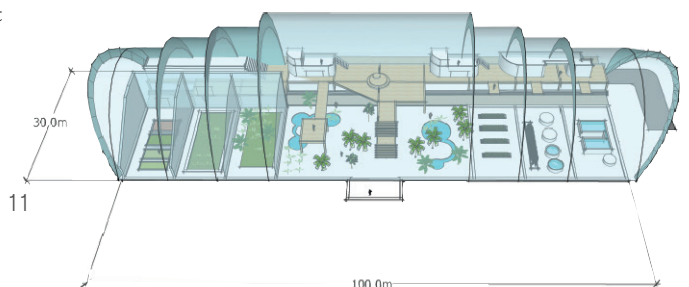
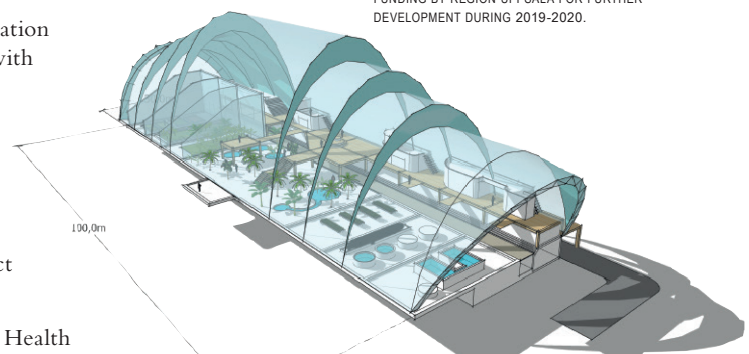

# FACTS & FIGURES

EDUCATION AT BASIC AND ADVANCED LEVEL

DOCTORAL EDUCATION

RESEARCH

EXTERNAL COLLABORATION

PUBLICATIONS

CONFERENCES

THE DEPARTMENT IN THE MEDIA

REPRESENTATION WITHIN SLU

FINANCIAL PERFORMANCE

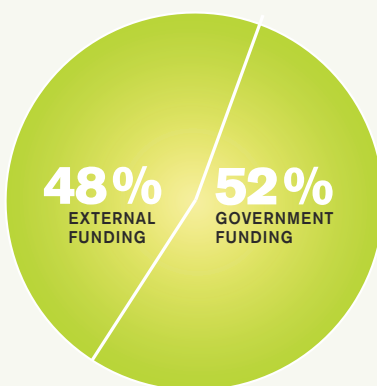
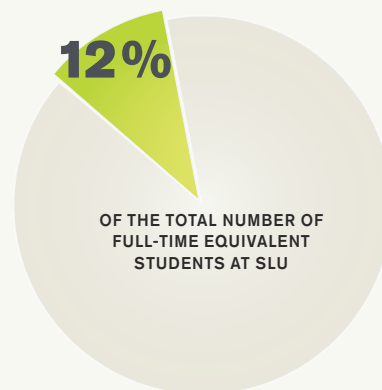

RESEARCH FUNDING

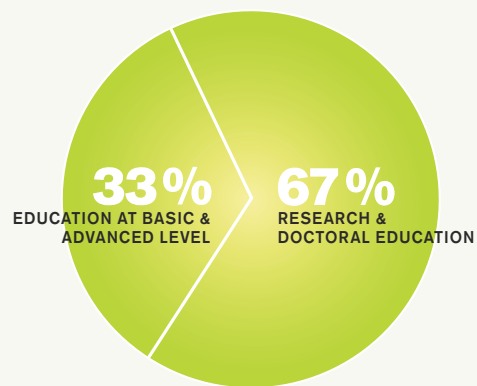

ACTIVITIES

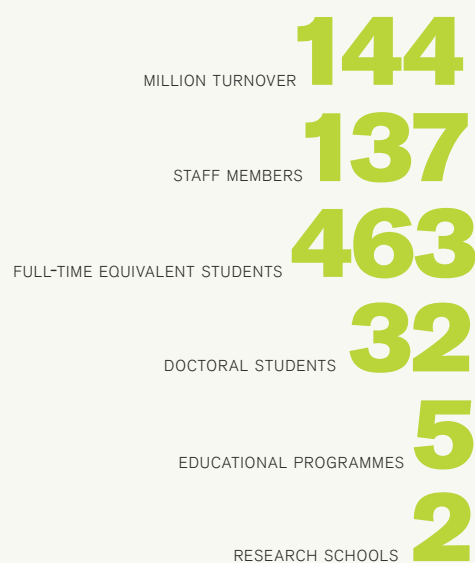
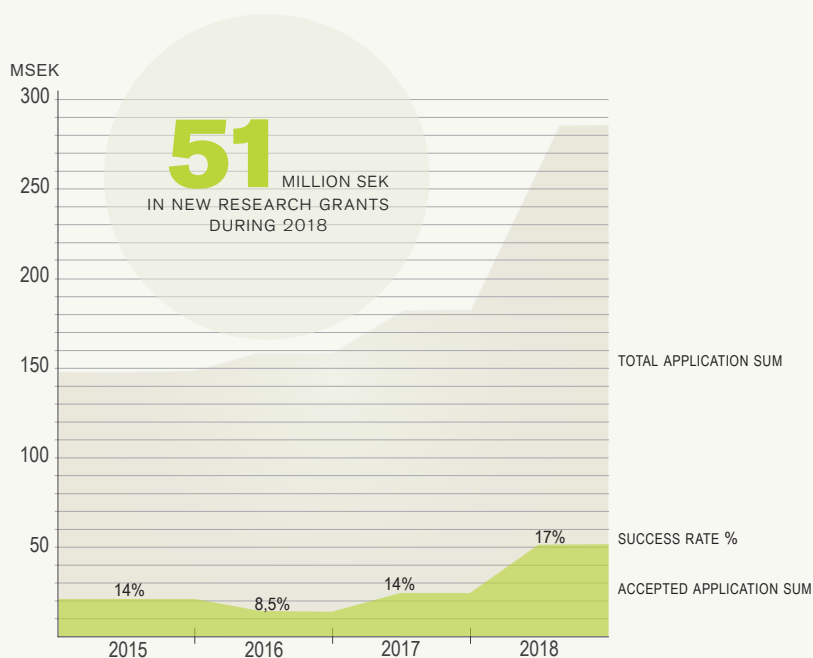

## EDUCATION AT BASIC AND ADVANCED LEVEL

Within the main subjects: environmental science, landscape architecture and rural development

Full-time equivalent students (HST) 463                      Annual performance equivalent (HPR) 451

Supervised/examined bachelor's theses in: landscape architecture 44    rural development 24

Supervised/examined master's theses in: environmental science 15    landscape architecture 31    rural development 24

### PROGRAMMES

Agronomist–Rural Development, 5 years

Landscape Architect–Uppsala, 5 years

Environmental Communication and Management, international master's programme, 2 years

Rural Development and Natural Resource Management, international master's programme, 2 years

Landscape Architecture for Sustainable Urbanisation, international master's programme, 2 years

### AWARDS AND SPECIAL ACHIEVEMENTS

#### **The Annual Theses' Scholarship of Uppsala Municipality**

*The Micro-Park: An inclusive place in the dense city* by Maria Walter, student at the Landscape Architect Programme–Uppsala;  
Supervisor: Antoinette Wärnbäck.

*Recreation Opportunity Spectrum: Adapting and Visualising the ROS-Method for Urban Natural Areas* by Ebba Johansson and Gerda Peterson, students at the Landscape Architect Programme–Uppsala; Supervisor: Ulla Myhr.

*The Agricultural Theatre: From the farmland to the people* by Oskar Mellegård and Henrik Lizell, students at the Landscape Architect Programme–Uppsala; Supervisor: Hildegund Nilsson Varhelyi.

#### **Global Swede Award**

Andrea María Cantillo Carrero, student at the international master's programme Environmental Communication

## DOCTORAL EDUCATION

Within the subjects: agrarian history, environmental communication, landscape planning and rural development

Total number of active students 32

- in agrarian history 5

- in environmental communication 5

- in landscape planning 15

- in rural development 8

Number of doctoral dissertations 3

Number of licentiate theses presented -

Number of admitted doctoral students 11

Number of admitted licentiate students -

Number of 50% seminars held 6

#### **Associate Professor's (Docent) Degrees**

Josefin Wangel, landscape architecture

Klara Fischer, rural development

### THE RESEARCH SCHOOL SOCIETY AND LANDSCAPE (2017-07-01—)

Director of studies: —2018-05-30 Camilla Eriksson, Researcher, Division of Rural Development

2018-06-01— Emil Sandström, Researcher, Division of Rural Development

#### **Courses**

*Philosophy of Science*, 5 credits. Course leaders: Örjan Bartholdson and Kjell Hansen. 8 participants (5 from Dept. of Urban and Rural Development).

*Critical Theory and Critical Realism*, 5 credits. Course leaders: Örjan Bartholdson and Kjell Hansen. 9 participants (4 from Dept. of Urban and Rural Development).

*Research ethics for qualitative methods*, 5/3 credits. Course leader: Per Sandin. 9 participants (7 from Dept. of Urban and Rural Development).

## Other activities

PhD writing retreat to Sunnersta herrgård.

PhD study trip *Stockholm City Planning and Architecture*.

THE RESEARCH SCHOOL SOCIAL SCIENCE PERSPECTIVES ON SUSTAINABLE DEVELOPMENT (2017-07-01—)

A collaboration with the Department of Economics, SLU.

Director of studies: Nina Lind, Postdoctor, Department of Economics.

## Courses

*Theoretical Topics in the Literature*, 7,5 credits, Course leader: Richard Ferguson. 2 participants (3 applied, 1 from Dept. of Urban and Rural Development and 1 from Dept. of Economics)

*To Communicate Science*, 2 credits (co-organised with the other research schools at NJ Faculty)

## Activities

*Nvivo workshop*, Facilitator: Nina Lind. Instructor: Fiona Wiltshier Alfasoft. 12 participants (10 doctoral students: 6 from Dept. of Urban and Rural Development)

Seminar: *How to become a Postdoc*. A one-day seminar in collaboration with the research schools: Focus on Soils & Water, Organism Biology, Ecology—Basics and applications, Focus on Food & Biomaterials.

Seminar: *Funding for Doctoral Students*. 13 participants.

Workshop: *Introduction, new PhD Student in Social Science*. Facilitator: Nina Lind. 10 participants.

Workshop: *Time Management*. Facilitator: Nina Lind. 17 participants.

Annual PhD Student Workshop. Facilitator: Nina Lind. 12 participants (6 from Dept. of Urban and Rural Development and 6 from Dept. of Economics).

*Career outside University*, A one-day seminar in collaboration with the research schools: Focus on Soils & Water, Organism Biology, Ecology—Basics and applications, Focus on Food & Biomaterials. 33 participants.

**51** MILLION SEK  
IN NEW RESEARCH GRANTS

## RESEARCH

ACTIVE PROJECT DURING 2018 (ORDERED BY SUBJECT, PROJECT LEADER AT THE DEPARTMENT)

### NEW PROJECTS (GRANTED FUNDING DURING 2018)

Agrarian History	Åsa Åhrland & Janken Myrdal	<b>Swedish Garden History, set of Volumes</b> The project aims to give a broad presentation of the history of garden culture in Sweden in two-volume publication. The approach is to create a synthesis, where research on artistic, social, cultural and economic aspects of the historical development is brought together and analysed, patterns and irregularities are revealed and new questions formed.	C F Lundströms stiftelse	2016–2019
Agrarian History	Jesper Larsson	<b>Cultural History Studies with a focus on Landscape and Settlement History</b> The project studies self-managment and globalisation, rural land exploitation and settlement development during the 17 <sup>th</sup> century Northern Scandinavia.	The Royal Swedish Academy of Letters, History and Antiquities/ Vice-Chancellor, SLU	2015–2021



Agrarian History	Jesper Larsson	<b>Self-Governing and Sami Communities, Transitions in Early Modern Natural Resource Management</b> The project analyses institutional change in natural resource governance in early modern (1550-1780) Sami communities, mainly in Lule Lappmark, Sweden.	The Swedish Research Council (Vetenskapsrådet)	2019–2021
Agrarian History	Kristina Nordéus	<b>Healthy Animals do not Need Antibiotics: The bans on antibiotic growth promoters in Sweden and in the EU</b> The aim of this project is to map and analyse contexts and events leading to the Swedish ban on antibiotic growth promoters in Swedish animal husbandry in 1986 and the Swedish efforts contributing to a similar ban being introduced in the EU in 2006. Why is Sweden a frontrunner regarding responsible use of antibiotics, how were these bans introduced and what were the consequences are central questions in this project, linking agrarian history to the concept of One Health.	NJ Faculty SLU	2017–2019
Agrarian History	Patrick Svensson	<b>Trade, Market, and Regional Development in Pre-industrial Sweden (1750–1850)</b> In this project, we aim to explain how the access to national and international markets affected regional performances in pre-industrial Sweden.	Jan Wallanders and Tom Hedelius stiftelse/ Tore Browaldhs stiftelse	2016–2019
Environmental Communication	Hanna Bergeå	<b>Communication between Hope and Ambiguity: Coordination in transformation of food systems towards circular economy</b> The project investigates how the circular economy (CE) is made sense of in food systems, and suggests methods to facilitate constructive collaboration between multiple players.	Swedish Research Council for Sustainable Development (Formas)	2019–2020
Environmental Communication	Hanna Bergeå	<b>Collaboration Between Research and Advisory Services in the Green Sector</b> This research project studies the collaborative phenomenon (samverkan) in the Swedish green sector. We investigate how collaboration as a governing idea and ideal is constructed and filled with meaning, the consequences this generates and how collaborative practices between research, advisory services and practitioners play out. The aim is to critically explore and provide a multidimensional perspective on collaboration as an idea, form of organization and practice. (Cooperation with SLU in Skara)	Sweden's Innovation Agency (Vinnova)	2015–2019
Environmental Communication	Lars Hallgren	<b>Beyond Idealistic Glorifications and Categorical Rejections: The co-construction of meaning in dialogue practices in natural resource management</b> The premise of this project is that consultation is a legitimate part of modern natural resource management but we need further understanding of how the communication in a consultation actually works in order to assess the conditions are required where they really contribute to the management in a relevant way, and how consultations should be designed to fulfill realistic goals and at the same time interest both organisers and participants. The objective of this project is to develop this foundation.	Swedish Research Council for Sustainable Development (Formas)	2017–2021
Environmental Communication	Sara Holmgren	<b>Perform: Perceiving the forest based economy</b> The aim of the project is to better understand regional disparities of national bioeconomy policies and the perceptions of a forest-based bioeconomy. We explore the diversity of perceptions and acceptance of a forest-based bioeconomy in Europe in order to foster participation of different forest stakeholders and the broader public through an informed and open dialogue.	European Forest Institute	2018–2020
Environmental Communication	Sara Holmgren	<b>How does Continuous Cover Forestry Used in Peri-Urban Forests Affect the Experiential Value of the Public? Qualitative och quantitative analysis</b> The aim of the project is to chart and evaluate the continuous cover forestry used in frequently visited forests and to illustrate how these methods are experienced by local residents and visitors in peri-urban forest environments and furthermore to illustrate how these new methods can be combined with other forest management systems in peri-urban areas.	The Swedish Forest Society Foundation (Stiftelsen Skogs-sällskapet)	2016–2018
Environmental Communication	Sara Holmgren	<b>Governing the Bioeconomy Transition: Actors, values and trade-offs</b> The aim of this project is to investigate how different stakeholders in the Swedish forest sector perceive the bioeconomy transition, and how different bioeconomy pathways affect different stakeholders. Gaining this knowledge facilitates a more legitimate governing of the bioeconomy transition, where different forest values and interests are balanced in inclusive and transparent decision-making processes. (Cooperation with Linköping University)	Swedish Research Council for Sustainable Development (Formas)	2017–2020

Environmental Communication	Sara Holmgren	<p><b>The Role and Responsibilities of the Municipalities in the Wording and Implementation of the Forest Policy: A study of the accountability of Swedish municipalities concerning the social value of forests and how this accountability in forest policies can be improved</b></p> <p>The project aims to chart the work done by municipalities in peri-urban forests and thereby their contribution to the implementation of the forest policy, and furthermore to study the agency of the municipalities on a national level concerning the making of forest policy.</p>	The Swedish Forest Society Foundation (Stiftelsen Skogssällskapet)	2016–2018
Environmental Communication	Sofie Joosse	<p><b>Greening Urban Lifestyles through Nudging and Participation</b></p> <p>In this project we study two governance strategies—nudging and participation—that are thought to be able to advance sustainable urban lifestyles. In the project we investigate power, ethics and potential for change of these governance strategies, and if and how the strategies can be combined. We do so through living labs. The results are meant to inform city planning.</p>	Swedish Energy Agency (Energimyndigheten)	2018–2021
Environmental Communication	Sofie Joosse	<p><b>Fish in the City: Possibilities for a local sustainable food system for fish</b></p> <p>The general aim of this research is to evaluate the (im)possibilities to socially organise local food systems. To this end I perform a comparative analysis of two case studies (Maine/New York and Uppland/Stockholm in Sweden) of locally based fish value-chains, i.e. fish produced and consumed within a limited area and outside of globalised production networks.</p>	Swedish Research Council for Sustainable Development (Formas)	2016–2019
Environmental Communication	Helena Nordström Källström	<p><b>Changing Animal Bodies: Breeding responses to environmental, economic and social pressures</b></p> <p>Through three case studies, this project will explore how breeding strategies, technologies and practices offer indications of how farmers and farming respond to changing agricultural settings. The cases will be examining: 1) the changing economic circumstances of poultry production, 2) the contested politics of traditional breeds 3) the environmental pressures faced by pollinating insects.</p> <p>(Cooperation with Centre for Gender Research at Uppsala University)</p>	Swedish Research Council for Sustainable Development (Formas)	2015–2018
Environmental Communication	Helena Nordström Källström	<p><b>Increased Profitability through new Breeding Tools for Dairy Cattle</b></p> <p>The aim is to study the possibility to improve profitability on herd level in Swedish milk production by using sexed semen and genotyping heifers in the dairy herds and combine this with planned crossbreeding and use of beef semen. The results from the study can be used as a basis for advisory service for a more profitable milk production.</p> <p>(Cooperation with the Department of Animal Breeding and Genetics, SLU)</p>	Swedish Farmers' Foundation for Agricultural Research (Stiftelsen lantbruksforskning)	2014–2018
Environmental Communication	Helena Nordström Källström	<p><b>Spot-IT: IT-Solutions for User Friendly IPM-Tools in Management of Leaf Spot Diseases in Cereals</b></p> <p>A Nordic-Baltic initiative to provide farmers with better models for predicting leaf spot diseases in wheat and barley, aiming for user-friendly, locally adapted IPM-tools. Improved management strategies, will contribute to increased food production, better economy for the growers and minimize negative impact on the environment.</p> <p>(Cooperation with the Department of Forest Mycology and Plant Pathology, SLU)</p>	Swedish Research Council for Sustainable Development (Formas)	2017–2020
Environmental Communication	Helena Nordström Källström	<p><b>Plant Protection for Sustainable Food Production</b></p> <p>Sustainable plant protection requires a common effort among all stakeholders, researchers and experts at authorities, in order to identify knowledge gaps and future research needs and to find new and innovative solutions for future challenges. We will conduct a synthesis over the state of art knowledge in plant protection, and the current implementation strategies available within Swedish agriculture. The aim is to identify knowledge gaps and differences between practice and current knowledge in risk management of plant pest and disease.</p> <p>(Cooperation with the Department of Forest Mycology and Plant Pathology, SLU)</p>	Swedish Research Council for Sustainable Development (Formas)	2017–2019
Environmental Communication	Stina Powell	<p><b>To Stop Counting Bodies: New ideas for a gender equal forest sector</b></p> <p>This project concerns how we can achieve gender equality in the forestry sector, focusing on SLU's forestry courses and programmes. The idea is to develop more knowledge about what gender equality means to different groups instead of counting bodies. In this way, we want to challenge what gender equality within forestry actually means.</p>	The Swedish Forest Society Foundation (Stiftelsen Skogssällskapet)	2018–2021

Environmental Communication	Stina Powell	<b>The Value of Stakeholder Participation in Collaborative Research Projects for Sustainable Development: A gender and intersectional analysis</b> Applying gender and intersectional analysis, this research studies three sustainable development research projects ostensibly based on collaborative approaches. This research examines the collaborative objectives and methodologies of these projects. This will reveal insights into using collaborative research approaches to improve the design of future research projects and improve practical application.	Swedish Research Council for Sustainable Development (Formas)	2018–2021
Environmental Communication	Kaisa Raitio	<b>Decolonizing Land use Planning: Reimagining Sami-state relations in Sweden and Finland (RE-LAND)</b> This project seeks to understand what decolonization could entail for the everyday practice of land use planning in Sami lands.	Swedish Research Council for Sustainable Development (Formas)	2019–2021
Environmental Communication	Kaisa Raitio	<b>Constructivity and Destructivity in NRM Conflicts: An analytical framework and methodology for understanding the role of communication and institutions in transforming conflicts</b> This project assumes that disagreement as such is not destructive, and that conflict processes include both constructive and destructive aspects. Society needs to distinguish between them to maintain constructivity and reduce destructivity. The project seeks to improve the theoretical and pragmatic understanding on the role of conflicts in natural resource management (NRM).	Swedish Research Council for Sustainable Development (Formas)	2015–2018
Environmental Communication	Kaisa Raitio	<b>Indigenous Rights and the Global Politics of Resource Extraction: The case of mining in Sapmi</b> Over the last two decades there has been a growing global acknowledgement of Indigenous land and resource rights. At the same time, there has also been a dramatic increase in extractive activities and infrastructure projects on traditional Indigenous lands. This research project investigates the increasingly complex politics of resource extraction on traditional Indigenous lands emerging from these two contradictory trends. The project aims to identify practical proposals for the recognition of Saami rights to land and resources through legal reforms and through institutional models for the co-management of natural resources.	Swedish Research Council for Sustainable Development (Formas)	2013–2019
Environmental Communication	Lotten Westberg	<b>Making Sense of Adaptation: The adaptation practice in a governance perspective</b> The project is structured in three, interrelated, parts: Zooming in on the adaptation practice to develop understanding of how it is enacted and why; zooming out focusing on how governance struggles and choices are handled (and which are not) and the potential implications for adaptation governance; looking forward by providing input for climate adaptation action.	Swedish Research Council for Sustainable Development (Formas)	2017–2021
Environmental Communication	Erica von Essen	<b>Challenges Facing Swedish Hunting Ethics in Post-Modernity</b> The purpose of this research is to outline, deconstruct and problematise the contemporary Swedish hunting ethic and the principal challenges that presently, and in the future, face it.	Viltvårdsfonden / Swedish Environmental Protection Agency	2018–2021
Environmental Communication	Erica von Essen	<b>What Makes Nordic Hunters Tick? Outlining the challenges facing the contemporary Nordic hunting ethic</b> This 2-year postdoctoral research project explores the do's and don'ts and taboos that exist on wildlife harvesting and killing among modern Swedish hunters. The findings will be corroborated by equivalent studies on Danish, Norwegian and Finnish hunters. This to meet the principal aim of the research project, which is to identify a common Nordic hunting ethic.	NJ Faculty, SLU	2016–2018
Environmental Communication	Elin Ångman	<b>VALKMAN: VALUE and Knowledge based scenarios for sustainable MANAGEMENT of forest landscapes</b> The overall objective of the research project is to integrate a set of tools and methods to a form a model for value and knowledge based guidance, planning and management of forest landscapes. The framework handles multiple ecosystem functions and services, as well as multiple species-habitat and biodiversity. (Cooperation with the Department of Forest Resource Management, SLU)	Swedish Environmental Protection Agency (Naturvårdsverket)	2016–2018
Landscape Architecture	Per G Berg	<b>Density and Sustainability: Norms in practice and the results of research</b> The main goals of this project is to provide a systematic review of international research on urban density and the practical use of densification strategies in practice. (Cooperation with Chalmers University of Technology)	Swedish Research Council for Sustainable Development (Formas)	2018–2019

Landscape Architecture	Per G Berg	<b>Vertical Densification: A functional densification urban challenge</b> The project investigates seven UNHabitat-derived criteria for sustainable community development in high- versus low housing areas. It strives to test hypotheses on: disconnection with public life; critical thresholds in high-rises; biophysical limits for sun-, sky- and green space access; compatibility with a lean mobility lifestyle; construction- and maintenance costs; dwellers' living budgets and if high-rises ever can be justified or even attractive for future sustainable cities?	Swedish Research Council for Sustainable Development (Formas)	2017–2020
Landscape Architecture	Daniel Bergquist	<b>SystemsLandscapes: A critical systems approach to urban sustainability (SysLa)</b> The aim of this project is to critically analyze if sustainability ambitions in urban districts result in quantifiable progression towards overall resource efficiency. We will develop an interdisciplinary approach in which urban districts are conceived as systems landscapes (SysLa) – site specific, context dependent, though globally nested, social-ecological systems operating at multiple scales of society and environment. The approach will be applied in a comparative case study in an urban district explicitly aiming to be 'sustainable', in Uppsala, Sweden.	Swedish Research Council for Sustainable Development (Formas)	2016–2019
Landscape Architecture	Andrew Butler	<b>Political Landscape</b> Politics is central to the way in which landscapes are understood, represented and governed. However, this topic has received remarkably limited attention to-date in landscape research. This project develops Nordic academic capacity in landscape politics and identifies an agenda for future research on this topic.	The Swedish Research Council (Vetenskapsrådet)	2019–2020
Landscape Architecture	Andrew Butler	<b>Landscape up in Smoke: Revealing the changing landscape related identity among people who previously used the area in their daily lives</b> The objective is to examine how landscape related identity, of those who recognise the present fire damaged area as their everyday landscape, has been affected by the fire. The study is using both quantitative and qualitative methods through surveys and interviews in order to get a picture of how the relationship to the forest have changed, in individuals as well as the society. (Collaboration with Department of Landscape Architecture, Planning and Management, SLU)	Swedish Research Council for Sustainable Development (Formas)	2015–2018
Landscape Architecture	Matthew Cashmore	<b>EAQ-Net Baltic EaP Network on Quality Control and Capacity Development in Environmental Assessment</b> EAQ-NET is a project funded by the Swedish Institute that seeks to develop a network on capacity and quality control in Environmental Assessment (EA). The network includes countries from the Baltic Sea Region and Eastern area Partnership countries.	Swedish Institute	2018–2019
Landscape Architecture	Rolf Johansson	<b>Strengthening Capacity on Research and Innovation for Sustainable Land and Environmental Management for Inclusive Development</b> A capacity building research cooperation programme with Ardhi University in Tanzania. (Cooperation with the International Science Programme at Uppsala University)	Swedish International Development Cooperation Agency (Sida)	2015–2020
Landscape Architecture	Mari Kågström	<b>DECODE: Community Design for Conflicting Desires</b> The aim of the project is to develop a key part of urban development process steering, designed to be utilised within the framework of Citylab (a national forum for sharing knowledge around sustainable development) and freely by municipalities, developers, real-estate managers, with different pre-conditions. The project develops supporting planning processes based on cross-sectoral collaboration between different divisions within municipalities, private sector and academia, and where citizens and local actors engage actively. (Cooperation with Swedish Royal Institute of Technology, KTH)	Sweden's Innovation Agency (Vinnova)	2017–2019
Landscape Architecture	Susan Paget	<b>Accessible Digital and Physical Playgrounds</b> The project aims at creating and developing accessible outdoor playgrounds for children with disabilities. The project addresses the accessibility aspects from two different perspectives; by creating playground with high play value in their local environment and by developing playgrounds accessible for children with disabilities in a social context with other children. (Cooperation with the Swedish Royal Institute of Technology, KTH)	Sweden's Innovation Agency (Vinnova)	2017–2018
Landscape Architecture	Susan Paget	<b>Digital and Physical Playgrounds (part 3)</b> The aim of the project is to make outdoor playgrounds more attractive for children in their local environment through a concept called DigiPlayScape, that integrates digital techniques with green playgrounds in residential courtyards.	Sweden's Innovation Agency (Vinnova)	2016–2018

Landscape Architecture	Mattias Qviström	<b>Reinterpreting Fitness Running: A topological study for healthy cities</b> Fitness running plays an important role when it comes to public health, but the knowledge of the history and the planning that was required for adapting the cities to running is very poor. This makes it difficult to adapt the modern cities to increased everyday exercise. This project aims at contributing to knowledge of the history of fitness running, its movement pattern and geography, and to develop new methods for assessing the needs and requirements for fitness running.	Swedish Research Council for Sustainable Development (Formas)	2014–2018
Landscape Architecture	Mattias Qviström	<b>Sustainable Leisure Mobilities in Compact Towns: Changing patterns of outdoor recreation in transit-oriented development (TOD)</b> The project aims to acknowledge the history of the welfare planning and its current role for sustainable TODs, reveal the current use of places for active outdoor recreation of the TOD inhabitants, and explore the possibilities to encourage sustainable mobilities in (TODs), with special emphasis on green structure planning.	Swedish Research Council for Sustainable Development (Formas)	2017–2020
Landscape Architecture	Mattias Qviström	<b>The Welfare Landscape Reassembled: Policies for sustainable outdoor recreation in times of urban densification</b> The project studies the heritage of the welfare state, the welfare landscape, and how it's values can be secured in densification projects.	Swedish Research Council for Sustainable Development (Formas)	2016–2021
Landscape Architecture	Josefin Wangel	<b>Design for a Socially Engaged Energy Efficiency in the Sustainable City</b> The project investigates how the concept of energy efficiency can be further developed in relation to the everyday habits encouraged by the design of the built environment; how energy efficiency has been expressed in the past sustainability efforts and how these aspirations could be better implemented in future environments for sustainable habits in relation to the technical progress made possible. The project's interdisciplinary research team will produce concrete design proposals on objects and environments with a focus on the physical form that examines how people to a higher extent could be encouraged to live sustainably with a focus on how we produce, use and relate to energy in everyday life. (Cooperation with KTH Royal Institute of Technology)	Swedish Energy Agency	2017–2020
Landscape Architecture	Josefin Wangel	<b>Performance Indicators for Neighbourhood Sustainability Certification</b> This project is part of the ongoing development of a Swedish certification system for sustainable neighborhoods, led by the Sweden Green Building Council (SGBC). The project aims to evaluate and refine principles for the certification system and to develop performance indicators. The performance indicators serve three purposes: 1) to assess the actual sustainability performance of a newly developed or refurbished neighborhood, 2) to provide a basis for elaborating what demands should be put on processes in the different phases of an urban development project, and 3) to monitor and/or assess the sustainability of already existing neighborhoods. (Cooperation with KTH Royal Institute of Technology)	Swedish Research Council for Sustainable Development (Formas)	2015–2019
Landscape Architecture	Antoinette Wärnbäck	<b>Energy-Efficient Logistics for Transportation of Soil and Rock Material in Södertörn</b> The project aims to increase energy and resource efficiency in the management of soil and rock masses from heavy transport in the Södertörn region. The project will: 1) Explore the energy, environmental and economic potential of more efficient management and logistics, intermediate storage in material banks, more effective truck transports and use of waterway transports. This is carried out as a case study in Södertörn. 2) Describe policy instruments needed to achieve the gains in energy efficiency and 3) Propose business models for this. (Cooperation with Luleå University of Technology)	Swedish Energy Agency	2015–2018
Landscape Architecture	Antoinette Wärnbäck	<b>The Applicability of the Environmental Objectives in Swedish EIA and Permission Processes (MERIT)</b> This project examines the Swedish County Administrative Boards in their monitoring of the joint impact on the environmental objectives made by individual activities. The purpose is to identify environmental quality objectives that could be attained by a proper handling in EIA- and permission processes, and by proposing improvements to the permission process in order to better contribute to the implementation of the environmental objectives. (Cooperation with the Swedish Environmental Research Institute, IVL)	Swedish Environmental Protection Agency (Naturvårdsverket)	2017–2020
Landscape Architecture	Burcu Yigit Turan	<b>Norra Sorgenfri Planned, Populated and Problematised: The role of social sustainability in urban renewal</b> An analysis of the role of social sustainability in the transformation of an urban industrial area in the city of Malmö, Sweden.	Swedish Research Council for Sustainable Development (Formas)	2018–2020



Landscape Architecture	Petter Åkerblom	<b>The Moving of Large Trees</b> The aim of this project is to produce an instructional film, a review of current knowledge and educational material on how to use modern techniques to move a large tree in urban settings to a new urban habitat.	Swedish Transport Administration	2017–2019
Rural Development	Seema Arora-Jonsson	<b>Restructuring the Rural North? Tensions and prospects for sustainable development</b> In the research we investigate how initiatives for intensified resource extraction are restructuring rural spaces. We employ a cross national comparison of two cases of mining initiatives in Sweden and Canada that share several geographical, resource, economic and social characteristics, but differ markedly in terms of indigenous government.	Swedish Research Council for Sustainable Development (Formas)	2016–2019
Rural Development	Malin Beckman	<b>Review of Community Driven Development</b> The purpose of the review is to analyze the experiences of 20 years' of decentralization processes in Vietnam. The World Bank and a number of donors, including Sida, have been active in supporting Vietnam to develop institutional forms of how local authorities can take a larger independent responsibility for development budgets and implementation of development investments. The fieldwork for the study and the writing of the report was done in cooperation with Mandala Consulting, a small consultancy company in Hanoi, Vietnam.	World Bank	2018
Rural Development	Johanna Bergman Lodin	<b>Evolving Gender Relations in Transforming Cassava Value Chains and Implications for Intrahousehold Nutrition and Health: The case of Tanzania</b> The project focuses on evolving gender relations in households, communities and cassava value chains in light of the rapid commercialization and increasing higher value added processing of the crop in Tanzania, and generates strategies and options for improving outcomes.	Swedish Research Council for Sustainable Development (Formas)	2013–2018
Rural Development	Linley Chiwona Karltun	<b>Market Driven Afforestation: Trajectories in social resilience and environmental sustainability under land-use intensification</b> The aim of the project is to identify and describe positive and negative trajectories in (i) rural household income and gender equity, (ii) agricultural production and food security, (iii) water-balance at landscape level and downstream, (iv) carbon sequestration in biomass and soil at landscape level and (v) soil fertility and long-term sustainability of agricultural and forest production, in the Amhara region in Ethiopia. (Cooperation with Department of Soil and Environment, SLU)	The Swedish Research Council (Vetenskapsrådet)	2019–2021
Rural Development	Linley Chiwona Karltun	<b>Urban Africa's Double Disease Burden and the Ameliorative Potential of Household Food Production</b> This research will investigate whether and how emerging evidence from capital cities and larger cities of the developing world of a growing simultaneous double burden of malnutrition (diseases of both under-nutrition e.g. stunting or wasting, and those of over-nutrition e.g. obesity, diabetes, heart disease) have validity in the context of smaller but rapidly developing cities, and to assess a potential ameliorative role for urban agriculture (UA). (Cooperation with Umeå University)	Swedish Research Council for Sustainable Development (Formas)	2015–2018
Rural Development	Alexandre Dubois	<b>Innovation far from Major Growth Centres: Policy and Practice to support economic development in Europe's northern periphery</b> How appropriate are theoretical perspectives developed in core regions when applied to the study, policy and practice of innovation in the periphery? This question will be answered by this project, which proposes two case studies of peripheral regions in the far north of Europe and thereby contributing to a re-balancing of the discourse around regional innovation and establish the periphery as a crucial element in our overall conception of economic development.	Swedish Research Council for Sustainable Development (Formas)	2019–2021
Rural Development	Alexandre Dubois	<b>ESPON BRIDGES: Territories with Geographical Specificities</b> Targeted analysis on how to “think and plan in areas of territorial cooperation”. The study takes as a starting point the Swiss experience in defining so-called “action areas” as new forms of soft governance spaces.	EU ESPON Programme	2017–2019
Rural Development	Alexandre Dubois	<b>Farming Futures in Borderline Communities of Sweden and Australia</b> The project investigates how changing local climatic conditions and urbanisation affects the transformation of agriculture-community linkages (ACL) in small communities that are located on critical climatic ‘lines’.	Swedish Research Council for Sustainable Development (Formas)	2018–2021

Rural Development	Camilla Eriksson	<p><b>Can We Produce Food During Crises? Vulnerabilities and resilience at farm level in Swedish agriculture</b></p> <p>The rapid restructuring of agriculture has resulted in increased specialisation, mechanisation, new high-tech equipment and information technology that has created new vulnerabilities. Knowledge on how we would manage food supplies in times of crises is very limited in Sweden today. This project will contribute to filling that gap through focusing on what vulnerabilities and what resilience are to be found in Swedish food production.</p>	Swedish Civil Contingencies Agency (MSB) / Future Agriculture, SLU	2015–2018
Rural Development	Camilla Eriksson	<p><b>Changing Animal Bodies: Breeding responses to environmental, economic and social pressures</b></p> <p>Through three case studies, this project will explore how breeding strategies, technologies and practices offer indications of how farmers and farming respond to changing agricultural settings. The cases will be examining: 1) the changing economic circumstances of poultry production, 2) the contested politics of traditional breeds 3) the environmental pressures faced by pollinating insects.</p> <p>(Cooperation with Centre for Gender Research at Uppsala University)</p>	Swedish Research Council for Sustainable Development (Formas)	2015–2018
Rural Development	Harry Fischer	<p><b>Institutional Networks and Self-organized Adaptation: Tracing the democratic architectures of climate response</b></p> <p>This project develops the concept of self-organized adaptation to explore how democratic political systems—comprised of multiple actors, institutions, and forms of state support—shape local responses to climate risk and change in Himalayan Nepal and India.</p>	The Swedish Research Council (Vetenskapsrådet)	2019–2021
Rural Development	Klara Fischer	<p><b>Improved Disease Control by Community Participation: The case of African swine fever in northern Uganda</b></p> <p>Using multidisciplinary participatory methods, this project investigates the multiple reasons for farmer's responses to disease, such as social pressures, poverty-related constraints, and lack of health and veterinary infrastructure. The project seeks to enable more effective policies for disease control, including promotion of control interventions that are feasible to self-sustainably implement</p> <p>(Collaboration with Swedish National Veterinary Institute)</p>	The Swedish Research Council (Vetenskapsrådet)	2018–2021
Rural Development	Klara Fischer	<p><b>Researchers Perspective on Gene Technology</b></p> <p>Few subjects have been so debated as genetically modified organisms (GMO). Who has participated in this public discourse? And which arguments have dominated over time? This is what we want to find out, and we also want to know what impact the discourse have had on the legislation. One of two research project, where we study the public discourse on biotechnology, see project below: The Debate on GM-Feed in Sweden and Swedish Farmers.</p> <p>(Cooperation with Mistra BioTech, SLU)</p>	The Swedish Foundation for Strategic Environmental Research (Mistra)	2017–2020
Rural Development	Klara Fischer	<p><b>The Debate on GM-Feed in Sweden and Swedish Farmers</b></p> <p>Few subjects have been so debated as genetically modified organisms (GMO). Who has participated in this public discourse? And which arguments have dominated the discourse over time? This is what we want to find out, and we also want to know what impact the discourse have had on the legislation. One of two research project, where we study the public discourse on biotechnology, se project above: Researchers Perspective on Gene Technology.</p> <p>(Cooperation with Mistra BioTech, SLU)</p>	The Swedish Foundation for Strategic Environmental Research (Mistra)	2017–2020
Rural Development	Noemi Gonda	<p><b>Exploring Governance Regimes through Agricultural Land Grabbing Dynamics</b></p> <p>This three-year project will investigate to what extent agricultural land grabbing processes affecting rural areas are inserted in broader governance struggles over power relations and identities.</p>	Swedish Research Council for Sustainable Development (Formas)	2019–2021
Rural Development	Flora Hajdu	<p><b>Can Cash Transfers have Long-Term Effects on Rural Livelihoods in Poor Countries?</b></p> <p>The project aims to investigate potential differences in livelihood stability between households that have received child grant for most of the past 14 years and households that have not, in rural South Africa. The aim is to discuss whether small cash transfers can have long-lasting effects on livelihoods, or if they mainly have direct effects on poverty reduction.</p>	Swedish Research Council for Sustainable Development (Formas)	2015–2018

Rural Development	Flora Hajdu	<b>Social Cash Transfers, Generational Relations and Youth Poverty Trajectories in Rural Lesotho and Malawi</b> The major recent innovation in policy responses to poverty in sub-Saharan Africa has been social cash transfer schemes (SCTs) which disburse cash to poor people. Few such programs have however been studied regarding their effects on youth and generational relations, considering that the cash is usually paid out to the elderly or those with children. This project does this through re-interviewing youth interviewed 10 years ago, looking at life trajectories. (Cooperation with Brunel University London, UK)	Economic and Social Research Council, Joint Fund for Poverty Alleviation Research (ESRC-DFID)	2015-2018
Rural Development	Flora Hajdu	<b>The Prospects for Swedish Farming: Agrarian change and household strategies</b> The aim of this study is to explore agrarian change and farm household strategies in Sweden in order to better understand the current transformations in farming as a basis for a future oriented analysis. How do farmers respond to various challenges? Who will be farming in the future?	Swedish Research Council for Sustainable Development (Formas)	2016-2019
Rural Development	Stephanie Leder	<b>Revitalizing Community-managed Irrigation Systems in the Context of Out-migration in Nepal</b> This project seeks to identify the pathways through which a greater engagement of marginal groups can help to revitalize collective natural resource management. Such bottom-up processes of change could be a vital part of a long-term transition towards more equal access to resources and improved food security in rural households of the Global South.	Swedish Research Council for Sustainable Development (Formas)	2019-2022
Rural Development	Kristina Marquardt	<b>The Practice of Resilience in Mountain Landscapes: Exploring risk and landscape investments in rural Nepal</b> This project investigates long-term landscape investments in order to understand how people's landscape use and economic and social structures are mutually constituted with very different outcomes for different social groups in a hierarchical society such as Nepal contributing to the growing body of socio-political nuanced understandings of resilience and adaptive capacity, as well as analyse and reflect on development and environmental changes in an integrated manner.	The Swedish Research Council (Vetenskapsrådet)	2019-2021
Rural Development	Andrea Nightingale	<b>Governing Climate Resilient Futures: Gender, justice and conflict resolution in resource management</b> This research probes the link between gender and social inequalities, conflict, and how they affect sustainable and resilient climate development pathways.	The Swedish Research Council (Vetenskapsrådet)	2019-2021
Rural Development	Andrea Nightingale	<b>Conflict, Violence and Environmental Change: Investigating resource governance and legitimacy in transitional societies</b> What produces conflict and violence in the face of environmental change? The aim of the project is to probe the concerns raised by environmental change for conflict and violence and to understand how we can respond more effectively to them. The outcome will be a concrete evaluation of how conflict and environmental change together create new vulnerabilities and points of empowerment for people and polities.	The Swedish Research Council (Vetenskapsrådet)	2016-2020
Rural Development	Andrea Nightingale	<b>Landscapes of Democracy: Politics, subjectivity and ecologies in environmental governance</b> Under what conditions does environmental governance become undermined by conflict and violence? The project pulls together 25 years of research in Nepal's forestry sector. An in-depth case study of gender and other social inequalities ('subjectivities'), everyday working of user-groups, role of the Forest Department and international organisations, and ecological change are brought together to address broader theoretical environmental governance questions of conflict, democracy and transformations of societies and ecologies.	The Swedish Foundation for Humanities and Social Sciences (Riksbankens jubileumsfond)	2017-2019
Rural Development	Andrea Nightingale	<b>WEGO</b> WEGO is a trans-national network that aims to develop a shared research and training agenda to educate the next generation of interdisciplinary social-environmental scientists on feminist political ecology in Europe. WEGO's research examines gender relations in community organising from a feminist-informed political ecology (FPE) framework. From an international and interdisciplinary perspective, WEGO looks at gender and power relations in community responses to the current climate, economic and environmental crises in different socio-ecological contexts.	European Commission (Horizon 2020)	2018-2021

Rural Development	Patrik Oskarsson	<b>Coal Conflicts: Participatory resource governance for improved sustainability and conflict resolution in India and Mozambique</b> The project explores the possibilities for a sustainable use of carbon through local resource management in two poor/poverty-stricken regions with major carbon assets, in the state of Jharkhand in East India and the Tete Province in northwestern Mozambique. Material collected during field work will be complemented with satellite data that will show changes in detailed land use related to coal mines.	Swedish Research Council for Sustainable Development (Formas)	2013-2019
Rural Development	Patrik Oskarsson	<b>Participatory Environmentalism: Mobilising citizens for air pollution mitigation and improved environmental health in India</b> This project examines the conditions which enable citizens to become actively engaged in pollution control for improved environmental health. It does this by enabling research participants to monitor household air pollution levels for a better understanding of local sources of pollution and personal exposure. The resulting improved knowledge of what pollution is and where it comes from is expected to support community mobilisation to mitigate pollution. The project is expected to add to our understanding of the factors which support citizens becoming active in pollution control and management activities.	Swedish Research Council for Sustainable Development (Formas)	2018-2021
Rural Development	Adam Pain	<b>Access to Land Resources Vulnerability and HIV/AIDS in Tanzania</b> A capacity building program, that intends to assess the contribution of the existing policies, instruments and legal frameworks on access, use and ownership rights on land resources by people living with HIV/AIDS in Tanzania. (Cooperation with the International Science Programme at Uppsala University)	Swedish International Development Cooperation Agency (Sida)	2015-2020
Rural Development	Adam Pain	<b>Forest and Agrarian Transition, Smallholder Practices and the New Forms of Land Governance: Building research collaboration among Brazil, Nepal and Peru</b> This project will support an existing four country research partnership investigating issues of forest land governance. Joint activities include analytical workshops, field work and networking will be undertaken.	The Swedish Research Council (Vetenskapsrådet)	2018-2021
Rural Development	Adam Pain	<b>Thinking Beyond REDD: Analysing smallholders' motivation and actions for ecosystem service management</b> This research proposes to rethink how ES management and climate mitigation measures can be achieved. While approaching ES from a landscape perspective, we seek to investigate smallholders' motivations and actions for ES management and how these might promote forest cover maintenance, and other forms of ES provision at the same time as it meet the small-holders' livelihood needs. This will be investigated by using ethnographic and PRA methods in two contrasting country case studies, Brazil and Nepal.	The Swedish Research Council (Vetenskapsrådet)	2015-2018
Rural Development	Katarina Pettersson	<b>Entrepreneurship as Empowerment? Gendered opportunities and challenges in entrepreneurial urban and peri-urban agriculture in Tanzania</b> This project will develop our understanding of entrepreneurial urban and peri-urban agriculture (UPA) in Dar-es-Salaam, Tanzania and how it is gendered.	Swedish Research Council for Sustainable Development (Formas)	2018-2021
Rural Development	Katarina Pettersson	<b>'Green care' on Farms in Sweden: A gender perspective on entrepreneurship in a changed welfare state</b> The aim of the project is to increase the knowledge on green care entrepreneurship on farms in Sweden in a gender perspective. The research questions include: Why and how do people on farms perform green care? In what ways are gendered divisions, symbols, identities, interactions and ownership, reproduced or challenged?	Swedish Research Council for Health, Working Life and Welfare (Forte)	2016-2019
Rural Development	Katarina Pettersson	<b>Keys to a Living Country-side: Various forms of entrepreneurship in interaction with the surrounding environment</b> The aim of the project is to develop new knowledge on the interaction between various forms of entrepreneurship and the surrounding country-side that influences the entrepreneurship developing there. (Cooperation with the Department of Economics, SLU)	The Kamprad Family Foundation for Entrepreneurship, Research and Charity	2017-2020
Rural Development	Katarina Pettersson	<b>Women's Entrepreneurship: For a living country-side?</b> Many of the new rural enterprises are owned and/or run by women. In order to stimulate rural development, more knowledge about the women's entrepreneurship is needed. Enterprising that remains invisible can neither be valued nor supported. This research project aims at making these women's enterprises visible. (Cooperation with Jönköping University)	The Kamprad Family Foundation for Entrepreneurship, Research and Charity	2018-2020

Rural Development	Erik Westholm	<b>What does the Future Hold?</b> Assessing the meaning of the long term in strategic and environmental research.	The Swedish Research Council (Vetenskapsrådet)	2014-2018
Rural Development	Erik Westholm	<b>Turbulence in the Welfare State: The reception of refugees on the Swedish Country-side</b> The Swedish country-side has undergone a demographic transformation during the last years. Through field studies the project explores how county organisations, municipalities and the civil society works in order to accommodate the arriving refugees. How are the established norms, practices and regulations affected by all the decisions made with a minimum of planning and coordination in order to solve urgent problems.	Swedish Research Council for Sustainable Development (Formas)	2016-2018

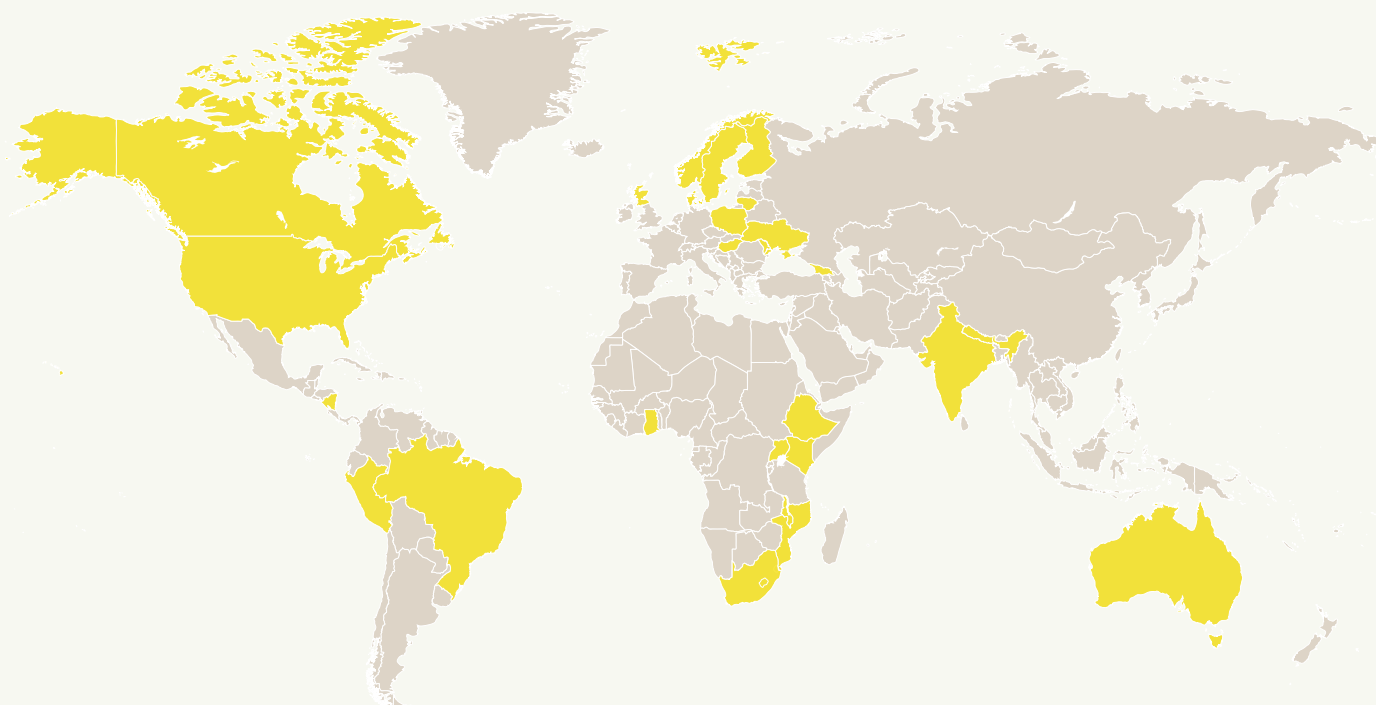

THE GEOGRAPHICAL DISTRIBUTION OF ACTIVE RESEARCH PROJECTS AT THE DEPARTMENT DURING 2018

## PUBLICATIONS

## DOCTORAL THESES

## ENVIRONMENTAL COMMUNICATION

**Caselunghe, E.** (2018). *Deliberations on Nature*. Diss. Acta Universitatis agriculturae Sueciae, 2018:68.

## RURAL DEVELOPMENT

**Engström, L.** (2018). *Development Delayed: Exploring the failure of a large-scale agricultural investment in Tanzania to deliver promised outcomes*. Diss. Acta Universitatis agriculturae Sueciae, 2018:40.

**Khatrī, D. B.** (2018). *Climate and Development at the Third Pole*. Diss. Acta Universitatis agriculturae Sueciae, 2018:41.

## PEER-REVIEWED ARTICLES

## AGRARIAN HISTORY

**Myrdal, J.** (2018). Kvinnosaksfrågan omkring år 1430. *Historisk tidskrift*, 138, pp. 63–77.

Frankelius, P., **Päiviö Sjaunja, E.-L.** & Isacson, M. (2018). Dissertation Review Essay. Så introducerades traktorn i det svenska lantbruket. *Historisk tidskrift*, 138 (2), pp. 327–333.

Bengtsson, E., Missiaia, A., Olsson, M. & **Svensson, P.** (2018). Aristocratic Wealth and Inequality in a Changing Society: Sweden 1750–1900. *Scandinavian Journal of History*, 44 (1), pp. 27–52.

Bengtsson, E., Missiaia, A., Olsson, M. & **Svensson, P.** (2018). Wealth Inequality in Sweden 1750–1900. *The Economic History Review*, 71 (3), pp. 772–794.

## ENVIRONMENTAL COMMUNICATION

**Grubbström, A.** & Eriksson, C. (2018). Retired Farmers and New Land Users: How relations to land and people influence farmers' land transfer decisions. *Sociologia Ruralis*, 58 (4), pp. 707–725.

**Hallgren, L., Bergeå, H. & Westberg, L.** (2018). Communication Problems when Participants Disagree (or Avoid Disagreeing) in Dialogues in Swedish Natural Resource Management: Challenges to agonism in practice. *Frontiers in Communication*, 3 (56), pp. 1–11.

Baycheva-Merger, T., Sotirov, M., **Holmgren, S.** & Selter, A. (2018). Institutional and Actor-Oriented Factors Constraining Expert-Based Forest Information Exchange in Europe: A policy analysis from an actor-centred institutionalist approach. *Forests*, 9 (3): 129.

**Joesse, S.** & Brydges, T. (2018). Blogging for Sustainability: The intermediary role of personal green blogs in promoting sustainability. *Environmental Communication*, 12 (5), pp. 686–700.

Berlin, A., **Nordström Källström, H.** & Olson, Å. (2018). Scientific Evidence for Sustainable Plant Disease Protection Strategies for the Main Arable Crops in Sweden: A systematic map protocol. *Environmental Evidence*, 7:31.

**Powell, S.** (2018) Gender Equality in Academia: Intentions and consequences. *International Journal of Diversity in Organisations, Annual Review*, 1 (18), pp. 19–35.

**Powell, S.**, Ah-King, M. & Hussenius, A. (2018). Are we to become a gender university? Facets of resistance to a gender equality project. *Gender, Work and Organization*, 25 (2), pp. 127–143.

**von Essen, E.** (2018). The Impact of Modernization on Hunting Ethics: Emerging taboos among contemporary Swedish hunters. *Human Dimensions of Wildlife*, 23 (1), pp. 21–38.

**von Essen, E.** (2018). "We Need to Talk...": Evolving Conversations about Ethics in Hunting Press 1960s–today". *Humanimalia*, 10 (1).

**von Essen, E.** & Hansen, H.P. (2018). Policing Peers between Law and Morality: A socio-legal perspective on managing misconduct in hunting. *International Journal of Rural Criminology*, 4(1) pp. 1–26.

Peterson, M. N., **von Essen, E.**, Hansen, H. P. & Peterson, T. R. (2018). Shoot, Shovel and Sanction Yourself: Self-policing as a response to wolf poaching among Swedish hunters. *Ambio*. doi:10.1007/s13280-018-1072-5.

Allen, M.P. & **von Essen, E.** (2018). Religion, Critical Animal Studies, and the Political Turn: Nonhuman Animal Belonging and Participation from Secular and Religious Perspectives. *Journal of Critical Animal Studies*, 15 (4), pp. 4–29.

**von Essen, E.** & Allen, M. (2018). Taking Prejudice Seriously: Burkean reflections on the rural past and present. *Sociologia Ruralis*, 58 (3), pp. 543–561.

Butler, A., Sarlöv-Herlin, I., **Ångman, E.**, Ode Sang, Å. & Åkerskog, A. (2018). Landscape Identity, Before and After a Forest Fire. *Landscape Research*, 43 (6), pp. 878–889.

Knez, I., Butler, A., Ode Sang, Å., **Ångman, E.**, Sarlöv-Herlin, I. & Åkerskog, A. (2018). Before and After a Natural Disaster: Disruption in emotion component of place-identity and wellbeing. *Journal of Environmental Psychology*, 55, pp. 11–17.

## LANDSCAPE ARCHITECTURE

**Bergquist, D.** & Hedfors, P. (2018). Design Criteria for Regenerative Systems Landscapes. *Nordic Journal of Architectural Research*, 30 (3), pp. 107–134.

Chmielewski, T., **Butler, A.**, Kulak, A. & Chmielewski, S. (2018). Landscape's Physiognomic Structure: Conceptual development and practical applications. *Landscape Research*, 43 (3), pp. 410–427.



- Knez, I., **Butler, A.**, Ode Sang, Å., Ångman, E., Sarlöv-Herlin, I. & Åkerskog, A. (2018). Before and After a Natural Disaster: Disruption in emotion component of place-identity and wellbeing. *Journal of Environmental Psychology*, 55 pp. 11–17.
- Butler, A.**, Sarlöv-Herlin, I., Ångman, E., Ode Sang, Å. & Åkerskog, A. (2018). Landscape Identity, Before and After a Forest Fire. *Landscape Research*, 43 (6), pp. 878–889.
- Nikodinoska, N., Paletto, A., Pastorella, F., **Granvik, M.** & Franzese, P. P. (2018). Assessing, Valuing and Mapping Ecosystem Services at City Level: The case of Uppsala (Sweden). *Ecological Modelling*, 368, pp. 411–424.
- Ignatieva, M.** & Hedblom, M. (2018). An Alternative Urban Green Carpet: How can we move to sustainable lawns in a time of climate change? *Science*, 362 (6411), pp. 148–149.
- Ignatieva, M.**, **Florgård, C.** & Lundin, K. (2018). Lawns in Sweden: History and etymological roots, European parallels and future alternative pathways. *Bebyggelsehistorisk tidskrift*, 75, pp. 26–47.
- Qviström, M.** (2018). Farming Ruins: A landscape study of incremental urbanisation. *Landscape research*, 43, pp. 575–586.
- De Block, G. & **Vicenzotti, V.** (2018). The Effects of Affect: A plea for distance between the human and non-human. *Journal on Landscape Architecture*, 13 (2), pp. 46–55.
- Vicenzotti, V.** & **Qviström, M.** (2018). Zwischenstadt as a Travelling Concept: Towards a critical discussion of mobile ideas in transnational planning discourses on urban sprawl. *European Planning Studies*, 26, pp. 115–132
- Yang, F.**, **Ignatieva, M.**, Larsson, A., Xiu, N. & Zhang, S. (2018). Historical Development and Practices of Lawns in China. *Environment and History*, 25 (1), pp. 23–54.

## RURAL DEVELOPMENT

- Arora-Jonsson, S.** & Basnett, B.S. (2018). Disciplining Gender in Environmental Organizations: The Texts and Practices of Gender Mainstreaming. *Gender, Work & Organization*, 25, pp. 309–325.
- Westholm, L. & **Arora-Jonsson, S.** (2018). What Room for Politics and Change in Global Climate Governance? Addressing gender in co-benefits and safeguards. *Environmental Politics*, 27 (5), pp. 917–938.
- McLeoad, E., **Arora-Jonsson, S.**, Masudac, Y. J., Bruton-Adam, M., Emauroise, C. O., Gorong, B., Hudlow, C. F., Jamesh, R., Kuhlken, H., Masike-Lirij, B., Musrasik-Carl, E., Otzelberger, A., Relang, K., Reywun, B. M., Sigho, B., Stinnett, C., Telleiq, J. & Whitford, L. (2018). Raising the voices of Pacific Island women to inform climate adaptation policies. *Marine Policy*, 93, pp. 178–185.
- Westholm, L. & **Arora-Jonsson, S.** (2018). What Room for Politics and Change in Global Climate Governance? Addressing gender in co-benefits and safeguards. *Environmental Politics*, 27, pp. 917–938.
- Chemura, A., Musundire, R. & **Chiwona-Karlton, L.** (2018). Modelling habitat and spatial distribution of the edible insect *Henicus whellani* Chop (Orthoptera: Stenopelmidae) in south-eastern districts of Zimbabwe. *Journal of Insects as Food and Feed*, 4(4), pp. 229–238.
- Chiwona-Karlton, L.** (2018). Molecular Anthropology of Cassava: A cultural ecology of plant varietal preferences. *Socialmedicinsk tidskrift*, 94(6), pp. 721–730.
- Mackay, H., Mugagga, F., Kakooza, L. & **Chiwona-Karlton, L.** (2017). Doing things their way? Food, farming and health in two Ugandan cities. *Cities & Health*, 1(2), pp. 147–170.
- Dubois, A.** (2018). Nurturing proximities in an emerging food landscape. *Journal of Rural Studies*, 57, pp. 1–12.
- Sörvik, J., Teräs, J., **Dubois, A.** & Pertodli, M. (2018). Smart Specialisation in Sparsely Populated Areas: Challenges, opportunities and new openings. *Regional Studies*, doi.org/10.1080/00343404.2018.1530752.
- Giordano, B. & **Dubois, A.** (2018). Combining Territory and Competitiveness in EU Regional Policy? Analyzing ERDF investment profiles in regions with specific geographical features. *Regional Studies*, doi.org/10.1080/00343404.2018.1495323.
- Engström, L.** & **Hadju, F.** (2018). Conjuring a Win-world: Resilient development narratives in a large-scale agro-investment in Tanzania. *Journal of Development Studies*, doi.org/10.1080/00220388.
- Bluwstein, J. & **Engström, L.** (2018). Between Dependence and Deprivation: The interlocking nature of land alienation in Tanzania. *Journal of Agrarian Change*, 18 (4), pp. 806–830.
- Fischer, H.** & Syed Shoaib, A. (2018). Reshaping the Public Domain: Decentralization, the Mahatma Gandhi National Rural Employment Guarantee Act (MGNREGA), and trajectories of local democracy in rural India. *World Development*, doi:10.1016/j.worlddev.2018.09.013.
- Fischer, K.** & **Hajdu, F.** (2018). The Importance of the Will to Improve: How 'sustainability' sidelined local livelihoods in a carbon-forestry investment in Uganda. *Journal of Environmental Policy and Planning*, 20 (3), pp. 328–341.
- Chenais, E. & **Fischer, K.** (2018). Increasing the Local Relevance of Epidemiological Research: Situated knowledge of cattle disease among Basongora Pastoralists in Uganda. *Front. Vet. Sci.* 5:119.
- Ansell, N., **Hajdu, F.**, van Blerk, L. & Robson, E. (2018). "My happiest time" or "my saddest time"? The spatial and generational construction of marriage among youth in rural Malawi and Lesotho. *Transactions of the Institute of British Geographers*, 43 (2), pp. 184–199.
- Khatrī, D. B.**, **Marquardt, K.**, **Pain, A.** & Ojha, H. (2018). Shifting Regimes of Management and Uses of Forests: What might REDD+ implementation mean for community forestry? Evidence from Nepal. *Journal of Forest Policy and Economics*, 92, pp. 1–10.
- Karki, R., Shrestha, K. K., Ojha, H., Paudel, N., **Khatrī, D. B.**, Nuberg, I. & Adhikary, A. (2018). From Forests to Food Security: Pathways in Nepal's Community Forestry. *Small-Scale Forestry*, 17 (1), pp. 89–104.
- Rådestad, C. & **Larsson, O.** (2018). Responsibilization in contemporary Swedish crisis management: expanding 'bare life' biopolitics through exceptionalism and neoliberal governmentality. *Critical Policy Studies*, doi:10.1080/19460171.2018.1530604.
- Marquardt, K.**, **Pain, A.**, **Bartholdson, Ö.** & Romero Rengifo, L. (2018). Forest Dynamics in the Peruvian Amazon: Understanding processes of change. *Small-scale Forestry*, doi.org/10.1007/s11842-018-9408-3p.
- Eksvärd, K. & **Marquardt, K.** (2018). From Change to Transitions? Learnings from environmental protection activities in Sweden. *Agroecology and Sustainable Food Systems*, 42(2), pp. 189–209.

- Nightingale, A. J.**, Bhattarai, A., Ojha, H. R., Sharan Sigdel, T. & Rankin, K. N. (2018). Fragmented Public Authority and State Un/making in the 'New' Republic of Nepal. *Modern Asian Studies*, 52 (3), pp. 849–882.
- Rankin, K. N., **Nightingale, A. J.**, Hamal, P. & Sigdel, T. S. (2018). Roads of Change: Political transition and state formation in Nepal's agrarian districts. *Journal of Peasant Studies*, 45 (2), pp. 280–299.
- Ahlborg, H. & **Nightingale, A. J.** (2018). Theorizing Power in Political Ecology: The where of power in resource governance projects. *Journal of Political Ecology*, 25 (1), pp. 1–21.
- Nightingale, A. J.** (2018). Geography's Contribution to the Sustainable Development Goals: Ambivalence and performance. *Dialogues in Human Geography*, 8 (2), pp. 196–200.
- Nightingale, A. J.** (2018). The Socioenvironmental State: Political authority, subjects, and transformative socationatural change in an uncertain world. *Environment and Planning E: Nature and Space*, 1( 4), pp. 688–711.
- Nightingale, A. J.** (2018). Nepal's Towering Climate Adaptation Challenges. *Current History: A Journal of Contemporary Affairs*, 117(798), pp. 135–141.
- Widengård, M., **Nightingale, A. J.**, Roberntz, P., Edman, T. & Carlson, A. (2018). Seeing Like a Standard: EU, sustainable biofuels, and land use change in Africa. *ACME: An International Journal for Critical Geographies*, 17 (1), pp. 49–87.
- Oskarsson, P.** & Bedi, H. P. (2018). Extracting Environmental Justice: Countering technical renditions of pollution in India's coal industry. *The Extractive Industries and Society*, 5 (3), pp. 340–47.
- Oskarsson, P.** & Lahiri-Dutt, K. (2018). India's Resource (Inter)Nationalism: Overseas mining investments shaped by domestic conditions. *The Extractive Industries and Society*. doi.org/10.1016/j.exis.2018.11.006.
- Mallett, R. & **Pain, A.** (2018). Post-War Recovery and the Role of Markets: Policy insights from six years of research. *Global Policy*, 9 (2), pp. 264–275.
- Berglund, K., Ahl, H., **Petersson, K.** & Tillmar, M. (2018). Women's Entrepreneurship, Neoliberalism and Economic Justice in the Postfeminist Era: A discourse analysis of policy change in Sweden. *Gender, Work and Organization*, 25 (5), pp. 531–556.
- Sartas, M.**, Schut, M., Hermans, F., van Asten, P. & Leeuwis, C. (2018). Effects of Multi-Stakeholder Platforms on Multi-Stakeholder Innovation Networks: Implications for research for development interventions targeting innovations at scale. *PLoS ONE*, 13 (6): e0197993.

## PEER-REVIEWED BOOK CHAPTERS

### AGRARIAN HISTORY

- Lennartsson, T., Eriksson, O., Iuga, A., **Larsson, J.**, Moen, J., Scholl, M. D., Westin, A. & Crumley, C. L. (2018). Diversity in Ecological and Social Context. In: Crumley, C. L., Lennartsson, T. & Westin, A. (Eds.) *Issues and Concepts in Historical Ecology: The past and future of landscapes and regions*. Cambridge, UK: Cambridge University Press, pp. 182–239.
- Lindkvist, T. & **Myrdal, J.** (2018). World Trade in the Fifteenth and early Sixteenth Centuries. In: Kristiansen, K., Lindkvist, T. & Myrdal, J. (Eds.) *Trade and Civilisation: Economic networks and cultural ties, from prehistory to the early modern era*. Cambridge, UK: Cambridge University Press, pp. 515–532.

### LANDSCAPE ARCHITECTURE

- Ahrland, Å.** (2018). Imagery of Birds of Prey and Falconry in the High and Late Middle Ages (1150–1500) in the Nordic Countries: Reflections of actual hunting practices or symbols of power? In: Gersmann, K.-H. & Grimm, O. (Eds.) *Raptor and Human: Falconry and bird symbolism throughout the millennia on a global scale*. Kiel: Wachholtz, Murmann Publishers.
- Berg, P.** & **Granvik, M.** (2018). Funktionell Täthet: Att balansera täthet och rymlighet i svenska städer. In: Olshammar, G., Olsson, K. & Siesjö, B. *Hus mot himlen hållbar hybrid?* Malmö: Bokförlaget Arena.
- Butler, A.** (2018). Landscape assessment as conflict and consensus. In: Egoz, S., Jørgensen, K. & Ruggeri, D. (Eds.) *Defining Landscape Democracy: A Path to Spatial Justice*. Cheltenham: Edward Elgard Publishing, pp. 85–95.
- Ignatieva, M.** (2018). Biodiversity Friendly Designs in Cities and Towns: Towards a global biodiversinesque style. In: Ossola, A. & Niemela, J. (Eds.) *Urban Biodiversity: From research to practice*. Francis and Taylor, pp. 216–235.
- Sarlöv-Herlin, I., Nordh, J. & **Qviström, M.** (2018). Landscape Characterisation in Sweden: Landscape in the planning system. In: *Routledge Handbook of Landscape Character Assessment*. London: Routledge, pp. 53–68.
- Qviström, M.** (2018). Peri-urban landscape studies. In: Howard, P., Thompson, I., Waterton, E. & Atha, M. (Eds.) *Routledge companion to landscape studies*, 2<sup>nd</sup> edition. London & New York: Routledge, pp. 523 - 533.
- Vicenzotti, V.** (2018). On the concept of landscape in landscape urbanism. In: Howard, P., Thompson, I., Waterton, E. & Atha, M. (Eds.) *The Routledge Companion to Landscape Studies*, 2<sup>nd</sup> edition. London & New York: Routledge, pp. 565–575.
- Höfer, W. & **Vicenzotti, V.** (2018). Post-Industrial Landscapes: Evolving concepts. In: Howard, P., Thompson, I., Waterton, E. & Atha, M. (Eds.) *The Routledge Companion to Landscape Studies*, 2<sup>nd</sup> edition. London & New York: Routledge, pp. 499–510.
- Yigit Turan, B.** (2018). Learning from Occupy Gezi Park: Redefining landscape democracy in an age of 'planetary urbanism'. In: Egoz, S., Jørgensen, K. & Ruggeri, D. (Eds.) *Defining Landscape Democracy: A path to spatial justice*. Cheltenham UK: Edward Elgard Publishing, pp. 210–221.
- Yigit Turan, B.** (2018). Revitalizing Yeldeğirmeni Neighbourhood in Istanbul: Towards an emancipatory urban design in the landscapes of neoliberal urbanism. In: Knierbein, S. & Videman, T. (Eds.) *Public Space Unbound: Urban emancipation and the post-political condition*. New York: Routledge, pp. 158–172.

### RURAL DEVELOPMENT

- Arora-Jonsson, S.** (2018). Across the Development Divide: A north-south perspective on environmental democracy. In: Marsden, T. (Ed.) *Sage Handbook of Nature*. London: Sage Publications, pp. 737–760.

- Jackson, J., & **Chiwona-Karlton, L.** (2018). Cassava Production, Processing and Nutrition. In: Siddiq, M. & Uebersax, M. A. (Eds.) *Handbook of Vegetables and Vegetable Processing* (2<sup>nd</sup> ed.). Wiley Blackwell, pp. 609-632.
- Chiwona-Karlton, L.**, Wamahu, M., Chabvuta, C., Ngonyama, D. & Demo, P. (2018). Supporting smallholder women farmers in potato cultivation. In: Wang-Pruski, . (Ed.) *Achieving sustainable cultivation of potatoes Volume 1, Breeding improved varieties*. Burleigh Dodds Science Publishing, pp. 285–292.
- Cras, P.** (2018). Service i framtidens landsbyggssamhällen. In: Syssner, J. (Ed.) *Nya visioner för landsbygden*. Boxholm: Linneförlag.
- Kristensen, I., **Dubois, A.** & Teräs, J. (2018). Introduction: Unveiling the Potential of Less Favoured Regions in Regional Policy. In: Kristensen, I., Dubois, A. & Teräs, J. (Eds.) *Strategic Approaches to Regional Development: Smart experimentation in less-favoured regions, Regions and Cities Series*. Oxon, UK & New York, USA: Routledge, pp. 1–14.
- Dubois, A.** & Kristensen, I. (2018). The role of biorefineries in the revitalization of (old) industrial rural regions. In: Kristensen, I., Dubois, A. & Teräs, J. (Eds.) *Strategic Approaches to Regional Development: Smart experimentation in less-favoured regions, Regions and Cities Series*. Oxon, UK & New York, USA: Routledge, pp. 103–120.
- Ylinenpää, H., Kristensen, I., **Dubois, A.** & Teräs, J. (2018). A Concluding Note: Future prospects of entrepreneurship and innovation policy. In: Kristensen, I., Dubois, A. & Teräs, J. (Eds.) *Strategic Approaches to Regional Development: Smart experimentation in less-favoured regions, Regions and Cities Series*. Oxon, UK & New York, USA: Routledge, pp. 246–253.
- Gromek, M. & **Dubois, A.** (2018). Digital Meetings: Real growth, better funding? An introduction to Swedish Crowdfunding. In: Teigland, R., Siri, S., Larsson, A., Moreno Puertas, A. & Ingram Bogusz, C. (Eds.) *The Rise and Development of Fintech: Accounts of disruption from Sweden and Beyond*. Oxon, UK & New York, USA: Routledge, pp. 223–237.
- Dubois, A.** & Gromek, M. (2018). How Does Distance Come into Play in Equity Crowdfunding? In: Teigland, R., Siri, S., Larsson, A., Moreno Puertas, A. & Ingram Bogusz, C. (Eds.) *The Rise and Development of Fintech: Accounts of disruption from Sweden and Beyond*. Oxon, UK & New York, USA: Routledge, pp. 376–389.
- Balachandran, G., Mallard, G., Arewa, O., Baccaro, L., Büthe, T., **Nightingale, A. J.** & Roberts, A. (2018). Governing Capital, Labor and Nature in a Changing World. In: *Rethinking Society for the 21<sup>st</sup> Century: Report of the International Panel on Social Progress: Volume 2: Political Regulation, Governance, and Societal Transformations*. Cambridge, UK: Cambridge University Press, pp. 491–522.
- Oskarsson, P.** & Kindo, N. (2018). Coal Trafficking: Reworking national energy security via coal transport at the north Karanpura coalfields, India. In: Pijpers, R. J. & Hylland Eriksen, T. (Eds.) *Mining Encounters: Extractive industries in an overheated world*. Oslo: Pluto Press, pp. 121–137.
- Waldenström, C.** (2018). Lantbrukets roll i framtidens landsbygd. In: Syssner, J. (Ed.) *Nya visioner för landsbygden*. Linneförlag.

## BOOKS

### AGRARIAN HISTORY

- Kristiansen, K., Lindkvist, T. & **Myrdal, J.** (Eds.) (2018). *Trade and Civilisation: Economic networks and cultural ties, from prehistory to the early modern era*. Cambridge, UK: Cambridge University Press, 552 pp.

### RURAL DEVELOPMENT

- Kristensen, I., **Dubois, A.** & Teräs, J. (Eds.) (2018). *Strategic Approaches to Regional Development: Smart experimentation in less-favoured regions, Regions and Cities Series*. Oxon, UK & New York, USA: Routledge, 258 pp.
- Leder, S.** (2018). *Transformative Pedagogic Practice. Education for Sustainable Development and Water Conflicts in Indian Geography Education*. Singapore: Springer Publisher. Education for Sustainability Book Series, 308 pp.
- Oskarsson, P.** (2018). *Landlock: Paralyzing dispute over minerals on Adivasi Land in India. Asia-Pacific Environment Monograph 14*. Canberra: Australian National University E Press, 225 pp.

## REPORTS

### AGRARIAN HISTORY

- Bengtsson, E. & **Svensson, P.** (2018). The Wealth of the Swedish Peasant Farmers Class 1750–1900: Composition and distribution, *Lund Papers in Economic History, General Issues*, no 177. Lund.

### ENVIRONMENTAL COMMUNICATION

- Sarlöv-Herlin, I., Knez, I., Butler, A., Sang, Å., **Ångman, E.** & Åkerskog, A. (2018). *Landskapet som gick upp i rök*. Uppsala: Swedish University of Agricultural Sciences; Gävle: University of Gävle.

### LANDSCAPE ARCHITECTURE

- Sarlöv-Herlin, I., Knez, I., **Butler, A.**, Sang, Å., Ångman, E. & Åkerskog, A. (2018). *Landskapet som gick upp i rök*. Uppsala: Swedish University of Agricultural Sciences; Gävle: University of Gävle.
- Isaksson, S. & **Kågström, M.** (2018). Vad innebär det att påverka? Reflektioner om samråd efter möte med kvinnor i Vårberg. *Rapport inom forskningsprojektet Decode: Design for conflicting desires*.
- Robinson T., Meurman, F. & **Kågström, M.** (2018). Kommunala politikers inställning till jordbruksmark i kommunal planering. *Final report, Ecoloop*, Stockholm.

## RURAL DEVELOPMENT

- Cras, P., Gunnarsdotter, Y. & Jonsson, Y.** (2018). Utvärdering av stöd till utbyggnad av bredband – Delrapport 1. *Utvärderingsrapport 2018:1*. Jönköping: Jordbruksverket.
- Sandström, E.** (ED.) (2018). Det småskaliga kustfiskets förändrade förutsättningar och mervärden. *Urban and Rural Report*, 2018:1. Uppsala: SLU, Department of Urban and Rural Development.
- Eriksson, C.** (2018). Livsmedelsproduktion ur ett beredskapsperspektiv. *SLU Future Food Reports 1*. Uppsala, SLU.

## SWEDISH CENTRE FOR NATURE INTERPRETATION

- Arnell, A., Sonnvik, P. & Näsström, C.** (2018). Naturvägledning i natur- och kulturområden. En handbok för planering och genomförande av naturvägledning i skyddade natur- och kulturområden. *Naturvårdsverkets rapport 6846*.

## OTHER PUBLICATIONS

### AGRARIAN HISTORY

- Nordéus, K.** (2018). Djurvälstånd och Antibiotikaresistens: Om den svenska modellen. *Manuscript in the Proceedings from Swedish Veterinary Congress*, November 9–10, 2018, Uppsala.
- Nordéus, K.** (2018). Djurvälstånd och Antibiotikaresistens: Om den svenska modellen. *Extended abstract at the Swedish Veterinary Congress*, November 9–10, 2018, Uppsala.
- Tollin, C.** (2018). Ödesåkrar och ödesbölen, vad säger Jämtlands och Ångermanlands äldsta kartor? *Lommen*, 54, pp. 24–30.

### ENVIRONMENTAL COMMUNICATION

- Bergeå, H., Kågström, M., Löf, A. & Westin, M.** (2018). Kännedom om dilemman kan leda till bättre samverkan. *Universitetsläraren*, November 19.
- von Essen, E.** (2018). Samma språk – olika natursyner. *Biodiverse*, 2/2018, pp. 12–13

### LANDSCAPE ARCHITECTURE

- Conti, A.** (2018). Design as Democracy: Techniques for collective creativity by de la Pena, D., Jones Allen, D., Hester, R. T., Hou, J., Lawson, L. J. & McNally, M. J. (Eds.) Reviewed in *Landscape Research*, 43 (5), pp. 749–750.
- Ignatieva, M. & Melnichuk, I.** (Eds.) (2018). Landscape architecture: Towards Sustainable Urban Environments. *Conference proceedings from ICON-LA Conference in June 6-7, Saint-Petersburg State Polytechnic University, Polytechnic University Publishing House*, 134 pp.
- Ignatieva, M., Golosova E., Melnichuk I. & Smertin, V.** (2018). Development of Biophilic Cities in Russia: From ideal scientific town and Ecopolis to the green strategy of the modern megapolis. *IFLA World Congress Singapore proceedings*, pp. 79–89.
- Bergeå, H., **Kågström, M.**, Löf, A. & Westin, M. (2018). Kännedom om dilemman kan leda till bättre samverkan. *Universitetsläraren*, November 19.
- Qviström, M.** (2018). Planera för löpning: Från motionscentraler till stadslandskap. *Faktablad (2018:2) Landvetter*: Marietorp Förlag AB.
- de Block, G. & **Vicenzotti, V.** (2018). The nature of post-human landscape design. In: Diedrich, L., Friesen, M., Hendriks, M., Lindgren, C. & Moll, C. (Eds.) *Landscape Architecture Europe #5: care/create/act*. Wageningen: Blauwdruk, pp. 149–155.
- Wangel, J.**, Hesselgren, M., Eriksson, E. & Broms, L. (2018). Revisiting Empowering Energy Futures: Practice-oriented and practice-orienting design. *Conference paper at SCORAI 2018*, June 27–30 in Copenhagen, Denmark.
- Hesselgren, M., Eriksson, E., **Wangel, J.** & Broms, L. (2018). Exploring Lost and Found in Future Images of Energy Transitions: Towards a bridging practice of provoking and affirming design. *Conference paper at Design Research Society 2018*, June 25–28 in Limerick, Ireland.
- Wangel, J.** (2018). Prognosen är död. *PLAN #4–5*, 2018.
- Wangel, J.** (2018). Hur minskar vi välfärdens fotavtryck? In: *Mot en hållbar framtid: Så genomför vi FN:s Agenda 2030 och de globala målen för hållbar utveckling, Global Utmaning*.
- Wangel, J.** & Gunnarsson-Östling, U. (2018). Jorden har dödlig feber. *BANG* (2018:1).
- Wangel, J.**, Diedrich, L. & Vogel, N. (2018). Konsten att skapa framtidsbilder. *STAD 20*.
- Yigit Turan, B.** (2018). Geopolitics of Place and Social Justice in Urban Design Studio. *Extended conference abstract at Roundtable organised at AESOP Annual Congress, MAKING SPACE FOR HOPE*, July 10–14, Gothenburg, Sweden.
- Yigit Turan, B.** (2018). Deciphering Constructed Migrant Subjectivities in Park Design: Towards a politicizing environmental design as cultural practice. *Extended conference abstract at Park Politics—International Conference*, June 7–9, 2018 in Vienna, Austria.
- Yigit Turan, B.** (2018). Landscape theory in design by Herrington, S. London: Routledge. Reviewed in *Landscape Research*, 43, pp. 1013–1014.

### RURAL DEVELOPMENT

- Cuadra, M.** (2018). Born Undernourished, Die Undernourished: We have to break that curse! *Blog*, [www.siani.se/blog/born-undernourished-die-undernourished-break-curse/](http://www.siani.se/blog/born-undernourished-die-undernourished-break-curse/).
- Cuadra, M.** (2018). Could maize be a curse for Africa? *Blog* [www.siani.se/blog/maize-curse-africa/](http://www.siani.se/blog/maize-curse-africa/).
- Gonda, N.**, Huybrechts, F., Rodríguez-Fablená, R. & Hecken, G. V. (2018). Political ecologists in solidarity with Nicaragua. *Blog*, [politicalecologynetwork.com/category/pollen-blog](http://politicalecologynetwork.com/category/pollen-blog).



- Gonda, N.** (2018). Championing Change in Rural Hungary: The role of emancipatory subjectivities in the construction of alternatives to illiberal authoritarian populism. *Working paper at ERPI 2018 International Conference Authoritarian Populism and the Rural World* on March 17–18, 2018 in The Hague, Netherlands.
- Leder, S.** (2018). Gender and space in the neo-liberal academy? Reflections from a feminist geographies summer school. *Gender, Place and Culture—a journal for feminist geography blog*.
- Larsson, O.** (2018). Foucault's Critical Ethics by Lynch, R. A. New York: Fordham University Press. Reviewed in *Foucault Studies*, 24, pp. 213–217.
- Oskarsson, P.** & Chanchani, D. (2018). Cleaning the Air in Your Room: Experience from Raipur. *Citizen Matters blog*.

#### SWEDISH CENTRE FOR NATURE INTERPRETATION

- Bergdahl, E., Hultman, S.-G. & **Sandberg, E.** (2018). *Interpretation: Kommunikation som gör skillnad*. Swedish translation of: Ham, S. H. (2013). *Interpretation: Making a difference on purpose*. Golden, Colorado, U.S.: Fulcrum Publishing, 194 pp.
- Sandberg, E.** (2018). Naturvägledning som verktyg för naturvård, *Biodiverse*, 4:2018.
- Swedish Center for Nature Interpretation (2018). *Praktisk interpretation för guider i natur- och kulturarv*. Swedish translation of: Ludwig, T. (2014). *The Interpretive Guide: Sharing heritage with people*. Bildungswerk Interpretation, 38 pp.

#### MASTER'S THESES 2018

##### ENVIRONMENTAL SCIENCE

- Augdoppler, Miriam. *Thinking outside the CAP: Reducing domestic cattle farming as strategy for resilient food systems, in the context of Sweden's defence policy*.
- Blankestijn, Wouter & Martin, Anna. *Testing the (legal) waters: Interpreting the political representation of a river with rights in New Zealand: "Let's talk to the river, instead of talking about the river"*.
- Di Pumpo, Angela. *Sustainability from farm to fork: Education and the social construction of the environment in an agro-food park—the case of F.I.CO*.
- Gallagher, Andrew. *Small-scale farmers' intentions to carry out conservation-oriented agriculture through participation in the Entry-Level Stewardship Agriculture Scheme: The role of attitudes and values in farming behaviour*.
- Hansson, Emma. *Which knowledge counts? A critical discourse analysis of a conflict between a wind power development company and Sami communities*.
- Hensle, Lara. *Creating knowledge and considering power: A frame analysis of science-policy communication*.
- Martin, Anna. *Water management in transition? Investigating the underlying reasons of low level of public participation in water planning in Hungary*.
- Montgomerie, Emily. *Trust between actors in wildlife management: In the context of the Swedish seal management and small-scale fishery controversy*.
- Nilsson, Sandra. *The practice of recycling: Understanding people's motivations and barriers*.
- Oldensjö, Emelie. *The practice of influencing: How zero waste YouTubers try to influence the reduction of waste through online communities*.
- Rigo Cavinato, Maria Eduarda. *Beyond milk: Framing milk and oat-drink campaigns in Sweden*.
- Sen, Felicia. *Opportunities in rooftop greenhouses in Stockholm: A study of the potential of commercial rooftop greenhouse urban agriculture in Stockholm*.
- Stoderegger, Yasmin. *Is there a win for conservation, livelihoods and governance? The implications of Broussonetia papyrifera as an ecological resource substitute: a field study in Uganda*.
- Valentini, Daniel. *Social acceptance of the Vesterhav Syd Wind Power Project: Quantitative and qualitative content analysis of social acceptance towards a wind power project in the Ringkøbing-Skjern Municipality at the west coast of Jutland, Denmark*.
- Wogel, Emma. *Coordination of tourism in the Swedish national parks: A case study of Kosterhavet National Park*.

##### LANDSCAPE ARCHITECTURE

- Abrahamsson, Linn. *Jubileumsparken: Ett gestaltungsforslag for Frihamnen i Göteborg med landskapsplanteringar ur ett långsiktigt perspektiv*.
- Alsawadi, Mina. *Mångfald bland resonemang och studenter: En studie om landskapsarkitektstudenter och landskapsarkitektens yrkesroll*.
- Axell, Lovisa. *Att lära känna en plats: En praktisk tillämpning av konstnären Andy Goldsworthys arbetssätt i Hågadalén*.
- Axling, Mathilda & Sandström, Agnes. *The Royal Climate Garden: A design proposal on how to adapt Kungsträdgården, Stockholm, to a warmer future climate*.
- Boberg, Ruth & Bergebo, Elsa. *Lekbar, lärbär, hållbar: Att utforma ett dialogverktyg för kvalitetsbedömning och utveckling av förskolegårdar*.
- Bäckström, Elvira. *Stråk: Ett gestaltungsprogram för Årstaparken, Uppsala*.
- Carlstén, Freija. *Zanzibar night light: A lighting plan for UNESCO World Heritage Zanzibar Stone Town*.
- Fackel, Lina. *Smyckeskrinet: En gestaltung av arbetsområdet i Uppsala Stadsträdgård*.
- Förling, Ella. *Förtätning av villaområden: Ett gestaltungsforslag for förtätning längs Norbyvägen*.
- Göthlin, Jonna. *En skog, en äng, en vik: Ett utvecklingsforslag for naturlek vid Tybblekullen i Örebro*.
- Hafliadóttir, Hrönn. *Reykjavik's roadsides: Using roadside vegetation as a source to increase biological diversity in urban environments*.
- Johansson, Julia & Sandström, Elli. *A resilient design approach to climate adaptation of coastal landscape: Exploring design principles in facing flood risk and rising sea levels*.
- Karimzadeh, Nima. *Sitting on the dock of the bay: A design proposal for the dock area at Kvarnholmen*.
- Kullander, Lisa & Karlsson, Rebecca. *Parkbryggan: En gestaltung av ett parkstråk i södra Ulleråker*.
- Lidberg, Simon. *Sitta vid växter: En möbelgrupp i trä som gynnar biologisk mångfald*.

Lundkvist, Annika. *Ullbo Woodlight garden: Ett ljussättningsförslag med fokus på estetik.*

Lönnström, Filip & Parke, Lovisa. *Noden, ett rum för resande: Ett gestaltningsförslag för Klarabergsviadukten i centrala Stockholm.*

Magnusson, Petronella. *Colourful voices: Centering LGBTQ+ perspectives of public spaces.*

Nilsson, Mona. *Grön klimatanpassning i fysisk planering: Förslag till åtta gröna strategier för Mariestads klimatanpassningsplan.*

Olsson, Ida. *In search of sustainable urban green infrastructure through an ecological approach: An investigation of the urban green landscape of Danderyd.*

Persson, Oskar. *Cykelbanan i fokus vid arbetspendling: En undersökning om konsekvenser i stadsbilden vid huvudnätsstandard.*

Renström, Tove. *Torbjörns torg: Ett idéförslag för hur dagvatten kan skapa ekologiska, sociala och estetiska värden i stadsrum.*

Samuelsson, Klara. *Artilleriparken: Upprustning av en park i Visby innerstad.*

Saramolki, Peyman & Gulve, Simon. *Landskapsarkitekten: En resa i kunskap från student till nyanställd inom den privata sektorn.*

Skoglund, Hanna. *Exempelstudie av regnbäddar i nordiskt klimat.*

Somby, Sanna. *Skolgårdens pusselbitar: Ett gestaltningsförslag inspirerat av högstadielävers önskemål.*

Thomasdotter, Fredrika & Payne, Helena. *Visa vattnet! Gestaltning av Hospitalparken i Ulleråker.*

Viksten, Frida. *Ut och Lek! Ett idéförslag för Brännans förskolegård vid Norrlandskusten.*

Wallstedt, Maria. *Att göra plats: För tjejers delaktighet och inflytande i utvecklingen av en jämställd aktivitetspark.*

Walter, Maria. *Flytt av stora träd som metod för att bevara gröna kulturmiljöer: Med fokus på parkmiljöerna runt Station Haga i Göteborg.*

Winroth, Ru Amanda. *Det sista filtret — Gårdfabriken i Kovik: En våtmark för ett friskare Östersjön med förutsättningar för lärande och utforskande.*

## RURAL DEVELOPMENT

Almgren, Rebecca. *In the hands of the next generation farmers: A study of farm succession in Västmanland.*

Biro, Josephine. *Drops of knowledge: A case study of the private water market in Guayaquil, Ecuador.*

Chacon Orozco, Esteban. *Beans, community and Ceproma: Comparative study of the transformation from self-consumption to market-oriented production in two communities in Costa Rica.*

Chifwafwa, Elvis. *Governing rural populations in Zambia: Examining how rural resettlement schemes are managed.*

Chorell, Joel. *Conceptualising ecosystem services and implications for human nature relations.*

Daving Göteborg. *New ways to distribute food: REKO-rings in Sweden.*

Engström, Eva. *Vatten, en gränslös resurs? En studie av kommunal samverkan runt vattentillgång inom avrinningsområden.*

Ernstsson, Stina. *I skuggan av skandalen: En studie om hästen i livsmedelskedjan i Sverige.*

Gustafsson, Sanna. *Cows and regulations: A qualitative study on semi-natural pastures in Kronoberg county.*

Heldmark, Lina. *Från idé till projektansökan: En fallstudie om en samverkansprocess gällande Stenhuset i Skokloster.*

Larsson, Karin. *Om allt går åt skogen: Organiseringen av den svenska livsmedelsberedskapen och skogsmiljöernas bidrag ur ett kapacitetsperspektiv.*

Lind, Lova. *Who gets what? The community forest user group's role in rebuilding communities.*

McCormack, Caitlin. *Key factors in the use of Agricultural Extension Services by women farmers in Babati District, Tanzania: The role of societal gender norms.*

Mevius, Sofia. *På upptäcktsfärd i Sagobygden: Hur det immateriella kulturarvet används i en bygd.*

Ndimbwa, Charles. *Crop production upgrading strategies and their role for household food security in Chamwino District, Tanzania.*

Okumu, Lucy Awino. *Assessing water security and urban poverty linkages: A case study of Mathare informal settlement in Nairobi, Kenya.*

Ortman, Tove. *Combining production with preservation: Livelihood strategies and innovations on nature pasture based farms in Dalsland, Sweden.*

Patrick, Boneza. *Striving for dignity: Insights of young people in Rwanda on youth engagement in agriculture and urban migration of rural youth.*

Sahlström, Emma. *"It's so much more than just sports...": A study of public health in the municipalities of Hultsfred and Vimmerby.*

Sencebé Condeso, Carol. *Biodiversity vs. consumption and agriculture: Analysis of discourses from the European Community on its effort to halt biodiversity loss.*

Strimell Flodqvist, Therese. *Knocking on the door: A study on nutritional education and women's empowerment on household level in rural Tanzania.*

Ulfbecker, Ebba. *Farming for food security: A critical study on the transition to post-fossil agriculture in Sweden.*

Wendler, Mascha. *Farming, resistance and coping in the occupied West Bank: A study of Palestinian agricultural actors' framing of farming.*

Widmark, Hugo. *Participation lost in translation? An assessment of local participation during the operational phase of nature reserves.*

## CONFERENCES ORGANISED BY STAFF MEMBERS AT THE DEPARTMENT

- Sep 17 Annual EIA Day organised by ESCRG-Environment Sustainability Collaborative Research Group, Facilitators were Matthew Cashmore and Mari Kågström, researchers at the Division of Landscape Architecture.
- Oct 8–9 Swedish Center for Nature Interpretation arranged a two-day conference on the theme Nature Interpretation for the Future. The conference was a part of their 10<sup>th</sup> anniversary celebration and gathered 120 participants from Sweden as well as from neighboring countries.

## URBAN AND RURAL DEVELOPMENT IN THE MEDIA

- Jan 03 TCO, *Klimatfrågans allvar – så kan vi agera* (Josefin Wangel, Landscape Architecture).
- Jan 09 DN.se, *Landskapsarkitekt: "Vi tränger in våra barn i små mörka kyffan"* (Petter Åkerblom, Landscape Architecture)
- Jan 22 Expressen, *Världsmästaren väljer bort flyget – ska bli helt fossilfri* (Elin Ångman, Environmental Communication)
- Jan 23 Sveriges Radio – Vetenskapsradion Historia, *Nationalstadsparken* (Clas Tollin, Agrarian History)
- Jan 31 Jaktjournalen, *Viltforskare delar på 7,7 miljoner kronor till nya projekt* (Erica von Essen, Environmental Communication)
- Feb 03 Upsala Nya Tidning, *Hon flyger inte – varken privat eller i jobbet* (Elin Ångman, Environmental Communication)
- Feb 04 RESURS, *Ett hållbart livsmedelssystem* (Annsophie Wahlström, Gunilla Leffler & Pernilla Johnsson, FutureFood)
- Feb 08 Tidningen Syre, *Svenska köp av kolkrediter döms ut* (Flora Hajdu, Rural Development)
- Feb 09 Jordbruksaktuellt, *Röster från Nordic Agro Summit* (Camilla Eriksson, Rural Development)
- Feb 20 ATL Lantbrukets Affärstidning, *Robust livsmedelsförsörjning avskräcker fienden* (Camilla Eriksson, Rural Development)
- Feb 26 Jaktmarker och Fiskevatten, *Svensk jaktetik under forskarens lupp* (Erica von Essen, Environmental Communication)
- Feb 26 *Jaktmarker och Fiskevatten*, *Vi måste uppträda korrekt* (Erica von Essen, Environmental Communication)
- Mar 15 Expertsvar.se, *Nya SLU-professorer föreläser i Uppsala* (Patrick Svensson, Agrarian History)
- Mar 18 SvD, *De rikas konsumtion är största problemet* (Josefin Wangel (et al.) Landscape Architecture)
- Mar 22 DN.se, *Självförsörjande – en ny grön våg?* (Emil Sandström, Rural Development)
- Mar 28 Via TT, *Skogssektorns jämställdhet under lupp i nytt projekt* (Stina Powell, Environmental Communication)
- Apr 05 Sveriges Radio – P4 Uppland, *Uppsalaforskare ska syna machokultur i skogsbranschen* (Stina Powell, Environmental Communication)
- Apr 06 Sveriges Radio - P4 Västerbotten, *SLU och Skogssällskapet i projekt mot machokultur och diskriminering* (Stina Powell, Environmental Communication)
- May 03 Upsala Nya Tidning, *Så ska Uppsala bli grönare och mer ekologiskt* (Sofia Eskilsson, Landscape Architecture)
- May 03 Uppgång, *Så ska Uppsala bli grönare och mer ekologiskt* (Sofia Eskilsson, Landscape Architecture)
- May 04 Naturvårdsverket Viltnytt, *Illegal jakt allt större problem för rovdjursförvaltningen* (Erica von Essen, Environmental Communication)
- May 07 Natursidan, *Ökande illegal jakt hotar svenska rovdjursstammar* (Erica von Essen, Environmental Communication)
- May 25 Svensk Jakt, *Symposium om Rewilding* (Erica von Essen, Environmental Communication)
- May 26 Upsala Nya Tidning, *En invasiv förtätning* (Fredrik Eriksson & Madeleine Granvik, Landscape Architecture)
- May 29 Expertsvar.se, *Ny rapport om livsmedelsberedskap vid kris och krig* (Camilla Eriksson, Rural Development)
- May 30 Forskning.se, *Hur får vi tag i mat om kriget kommer?* (Camilla Eriksson, Rural Development)
- Jun 01 Biståndsaktuellt, *Landbruk og mat gikk i minus* (Linda Engström, Rural Development)
- Jun 09 Svensk Jakt, *Forskaren: Myndigheterna kan vara på väg att tappa greppet* (Erica von Essen, Environmental Communication)
- Jun 12 Svt.se, *Familjen Lindblom bytte staden mot landet: "Tillfredsställande att dra upp egna morötter"* (Emil Sandström, Rural Development)
- Jun 12 Svt.se, *Djurkollektiv populära på Björkö* (Emil Sandström, Rural Development)
- Jun 29 Svenska Dagbladet, *När Lammen Tystnar* (Erica von Essen, Environmental Communication)
- Jul 04 Miljö & Utveckling, *Radikala förslag för klimatet* (Josefin Wangel, Rural Development)
- Jul 05 Livsmedel.se, *10 heta tips: "Låt konsumenterna vara med och innovera"* (Thomas Norrby, Rural Development)
- Jul 06 Helagotland.se, *Minglet tog bussen till Pratkvarnen i Väte* (Thomas Norrby, Rural Development)
- Jul 09 Svensk Jakt, *Med naturen som religion* (Erica von Essen, Environmental Communication)
- Jul 24 Sveriges Radio – P4 Uppland, *Skaffa höns – del i en större grön våg* (Emil Sandström, Rural Development)
- Jul 30 Svenska Dagbladet, *Vargen dödade drömmen: "Det var en massaker"* (Erica von Essen, Environmental Communication)
- Aug 02 Upsala Nya Tidning, *Nu hotas lerjorden av fyrspåret* (Clas Tollin, Agrarian History)
- Aug 02 Uppgång, *Nu hotas lerjorden av fyrspåret* (Clas Tollin, Agrarian History)
- Aug 02 Sveriges Radio – P4 Uppland, *Parker hade förhindrat översvämningen vid resecentrum* (Per Berg, Landscape Architecture)
- Aug 08 Svenska Yle, Åbo Finland, *Mindre blod och färre döda djur i skandinaviska jakttidningar – 260 experter och forskare diskuterar djurens intelligens och välmående* (Erica von Essen, Environmental Communication)

Aug 09 Livsmedel.se, *Festival sprider kunskap om hållbara matval* (Richard Tellström, SLU Future Food)

Aug 09 Thatsup – Stockholm, *Kunskapsfestival för hälsa och hållbarhet* (Richard Tellström, SLU Future Food)

Aug 20 Expertsvar.se, *Dags för "Matologi" – SLU:s kunskapsfestival för hälsa och hållbarhet* (Richard Tellström, SLU Future Food)

Aug 26 Upsala Nya Tidning, *Hållbarhet i fokus i kulturprogram* (Clas Tollin, Agrarian History)

Aug 26 Uppgång, *Hållbarhet i fokus i kulturprogram* (Clas Tollin, Agrarian History)

Aug 30 Tidningen Syre, *"Folk vill köpa växter med en historia"* (Clas Tollin, Agrarian History)

Sep 26 Uppgång, *Var ska skolbarnen leka?* (Petter Åkerblom, Landscape Architecture)

Sep 26 Upsala Nya Tidning, *Var ska skolbarnen leka?* (Petter Åkerblom, Landscape Architecture)

Sep 28 Uppgång, *Hämtmat är en jättegammal sak* (Richard Tellström, SLU Future Food)

Sep 28 Upsala Nya Tidning, *Hämtmat är en jättegammal sak* (Richard Tellström, SLU Future Food)

Oct 02 Sveriges Radio – P4 Uppland, *Etik i älgjakten* (Erica von Essen, Environmental Communication)

Oct 11 Uppgång, *Uppsalaforskare: Dags att slopa gräsmattan* (Maria Ignatieva, Landscape Architecture)

Oct 11 Upsala Nya Tidning, *Uppsalaforskare: Dags att slopa gräsmattan* (Maria Ignatieva, Landscape Architecture)

Oct 12 Sciencemag.org/podcast, *What we can learn cluster people inherited intellectual disability and questioning how sustainable green lawns are in dry places* (Maria Ignatieva, Landscape Architecture)

Oct 12 Deutschlandfunk, *Alternativen zu rasenflaechen. Ein plaedoyer fuer mehr Wildnis in der Stadt* (Maria Ignatieva, Landscape Architecture)

Oct 16 Svt.se, *Därför följer så många svenskar dieter* (Richard Tellström, SLU Future Food)

Oct 16 Samtiden, *Forskare: Mat har blivit religion i Sverige* (Richard Tellström, SLU Future Food)

Oct 24 Forskning.se, *Svenskt bistånd fick negativa konsekvenser för lokalbefolkningen* (Linda Engström, Rural Development)

Oct 24 Expertsvar.se, *Tvivelaktigt bistånd till storskaligt jordbruk i Tanzania* (Linda Engström, Rural Development)

Oct 26 Altinget, *Så kan svenskt jordbruksbistånd undvika att misslyckas* (Linda Engström, Rural Development)

Oct 28 DN.se, *Karin Bojs: Med ögon indoktrinerade av för mycket grönt* (Maria Ignatieva, Landscape Architecture)

Oct 28 DN Debatt, *Universiteten måste själva börja klimatomställningen* (Josefin Wangel (*et al.*) Landscape Architecture)

Nov 01 Uppgång, *Studenterna ritar framtiden* (Lena Steffner, Landscape Architecture)

Nov 01 Upsala Nya Tidning, *Studenterna ritar framtiden* (Lena Steffner, Landscape Architecture)

Nov 01 Jaktojägare 11, *Etiken värnar om synen på jakt* (Erica von Essen, Environmental Communication)

Nov 01 Svensk Jakt, *Jägareförbundet: Vi står upp för legal vargjakt* (Erica von Essen, Environmental Communication)

Nov 02 Uppgång, *Forskare: Universiteten måste ta miljöansvar* (Josefin Wangel, Landscape Architecture)

Nov 02 Upsala Nya Tidning, *Forskare: Universiteten måste ta miljöansvar* (Josefin Wangel, Landscape Architecture)

Nov 03 Örebro nyheter, *Tvivelaktigt bistånd till storskaligt jordbruk i Tanzania* (Linda Engström, Rural Development)

Nov 06 Upsala Nya Tidning, *Barnen flyttar upp på taken* (Susan Paget, Landscape Architecture)

Nov 06 Uppgång, *Barnen flyttar upp på taken* (Susan Paget, Landscape Architecture)

Nov 06 Hallandsposten.se, *Hög tid att avskaffa enprocentsmålet* (Linda Engström, Rural Development)

Nov 08 MVT, *Avskaffa enprocentsmålet* (Linda Engström, Rural Development)

Nov 08 Cision, *Lantmännens podcast Matsamtalet* (Richard Tellström, SLU Future Food)

Nov 08 Bohuslänningen, *Därför har biståndspolitikern problem* (Linda Engström, Rural Development)

Nov 08 Ystads Allehanda, *Dags att avskaffa enprocentsmålet* (Linda Engström, Rural Development)

Nov 08 Trelleborgs Allehanda, *Dags att avskaffa enprocentsmålet* (Linda Engström, Rural Development)

Nov 09 Ttela.se, *Dags att avskaffa enprocentsmålet* (Linda Engström, Rural Development)

Nov 09 Aftonkuriren, *Lantmännens podcast Matsamtalet* (Richard Tellström, SLU Future Food)

Nov 11 Blekinge Läns Tidning, *Dags att avskaffa enprocentsmålet* (Linda Engström, Rural Development)

Nov 13 Extrakt, *Hållbarhetsforskarnas råd till nästa regering* (Josefin Wangel, Landscape Architecture)

Nov 19 Universitetsläraren, *Kännedom om dilemman kan leda till bättre samverkan* (Annette Löf, Hanna Bergeå & Martin Westin, Environmental Communication; Mari Kågström, Landscape Architecture)

Nov 21 Skogsaktuell, *Skogsnäringen behöver inte en långsam jämställdhetsprocess* (Ann Grubbström & Stina Powell, Environmental Communication)

Nov 22 RESURS, *Utbildning i landsbygdsutveckling blev en succé* (Yvonne Gunnarsdotter, Rural Development)



- Nov 23 ETC, *Veckans fråga: Varför äter män så mycket kött?* (Richard Tellström, SLU Future Food)
- Dec 03 ABC NEWS Australia, *Lawn porn and australia's love of green grass harming environment* (Maria Ignatieva, Landscape Architecture)
- Dec 10 Via TT, *Forskning på hållbar utveckling visar vägen mot de globala målen* (Kristina Marquardt, Andrea Nightingale & Harry Fischer, Rural Development)
- Dec 11 Örebroyheter, *Forskning på hållbar utveckling visar vägen mot de globala målen* (Kristina Marquardt, Harry Fischer & Andrea Nightingale, Rural Development)
- Dec 14 Sveriges Radio - *Släktband, Naturreсурser och konflikter* (Jesper Larsson, Agrarian History)

## REPRESENTATION WITHIN SLU

Deputy Vice-Chancellor: Karin Holmgren

SLU Board for Education: Yvonne Gunnarsdotter (deputy member)

SLU Council for External Collaboration: Hanna Ljunggren Bergeå

SLU Web Committee: Petter Åkerblom

NJ Faculty Vice Dean for External Collaboration (Working Committee and Faculty Board): Hanna Ljunggren Bergeå

NJ Faculty Board: Carin Martiin

NJ Faculty Program Board of Education at Bachelor's and Master's level: Lotten Westberg

NJ Faculty Docent Board: Patrick Svensson (deputy members)

NJ Faculty Academic Appointment Board: Seema Arora-Jonsson & Kjell Hansen (deputy members)

NJ Faculty Board of Doctoral Education: Jesper Larsson (deputy member)

NJ Faculty Election Committee: Klara Fischer

NJ Faculty Committee for Global Development: Andrea Nightingale

NJ Faculty Committee for Scholarships: Ylva Dahlman

NJ Faculty Committee for Equal Opportunities: Marina Queiroz (Chair) & Patrik Oskarsson

NJ Faculty Representative in the Board of Future Animals, Nature and Health: Eva Sandberg

LTV Faculty Board: Kerstin Nordin

LTV Faculty Election Committee: Ulla Myhr

LTV Faculty Board of Education: Ulla Myhr

Member of the Nomination Board for August T. Larsson Guest Researcher Programme at the NJ Faculty: Carin Martiin

Movium Management Council: Lars Johansson

## FINANCIAL PERFORMANCE

	2013	2014	2015	2016	2017	2018
Total turnover	86	98	110	127	132	<b>144</b>
Whereof government funding	56	59	73	77	89	<b>94</b>

**Largest funding organisations**

Swedish Research Council for Sustainable  
Development (Formas)

Swedish Environmental Protection Agency  
(Naturvårdsverket)

Swedish International Development Cooperation  
Agency (Sida)

Swedish Research Council (Vetenskapsrådet)

**Staff**

Full-time equivalent	78	82	89	92	94	<b>102</b>
Total number	112	107	125	120	128	<b>137</b>

**Full-time equivalent students**

Basic and advanced level	403	409	439	431	444	<b>463</b>
Doctoral students	28	28	42	35	30	<b>32</b>

**Annual performance equivalent**

Basic and advanced level	334	406	414	397	389	<b>451</b>
--------------------------	-----	-----	-----	-----	-----	------------

**Dissertations**

5	2	3	11	6	<b>3</b>
---	---	---	----	---	----------

**Publications**

Independent and degree projects	106	117	123	134	134	<b>138</b>
Doktoral and licentiate theses	5	2	3	12	6	<b>3</b>
Peer-reviewed articles	21	16	35	60	74	<b>63</b>
Peer-reviewed book chapters	6	3	10	34	16	<b>24</b>
Books	1	-	2	6	7	<b>4</b>
Reports	2	4	5	9	14	<b>9</b>
Other publications	2	12	23	14	34	<b>30</b>



Responsible publisher: Lars Johansson  
© Department of Urban and Rural Development, 2019  
Print: Repro SLU, Uppsala



Swedish University of Agricultural Sciences SLU  
Department of Urban and Rural Development  
Postal address: P.O. Box 7012, SE-750 07 Uppsala  
Visiting address: Ulls väg 27  
Delivery address: Ulls gränd 1  
Phone: +46 18 67 10 00  
[www.slu.se/sol](http://www.slu.se/sol)